

1 EXISTING SHADOW DIAGRAM- JUNE 21- 8AM  
1 : 500

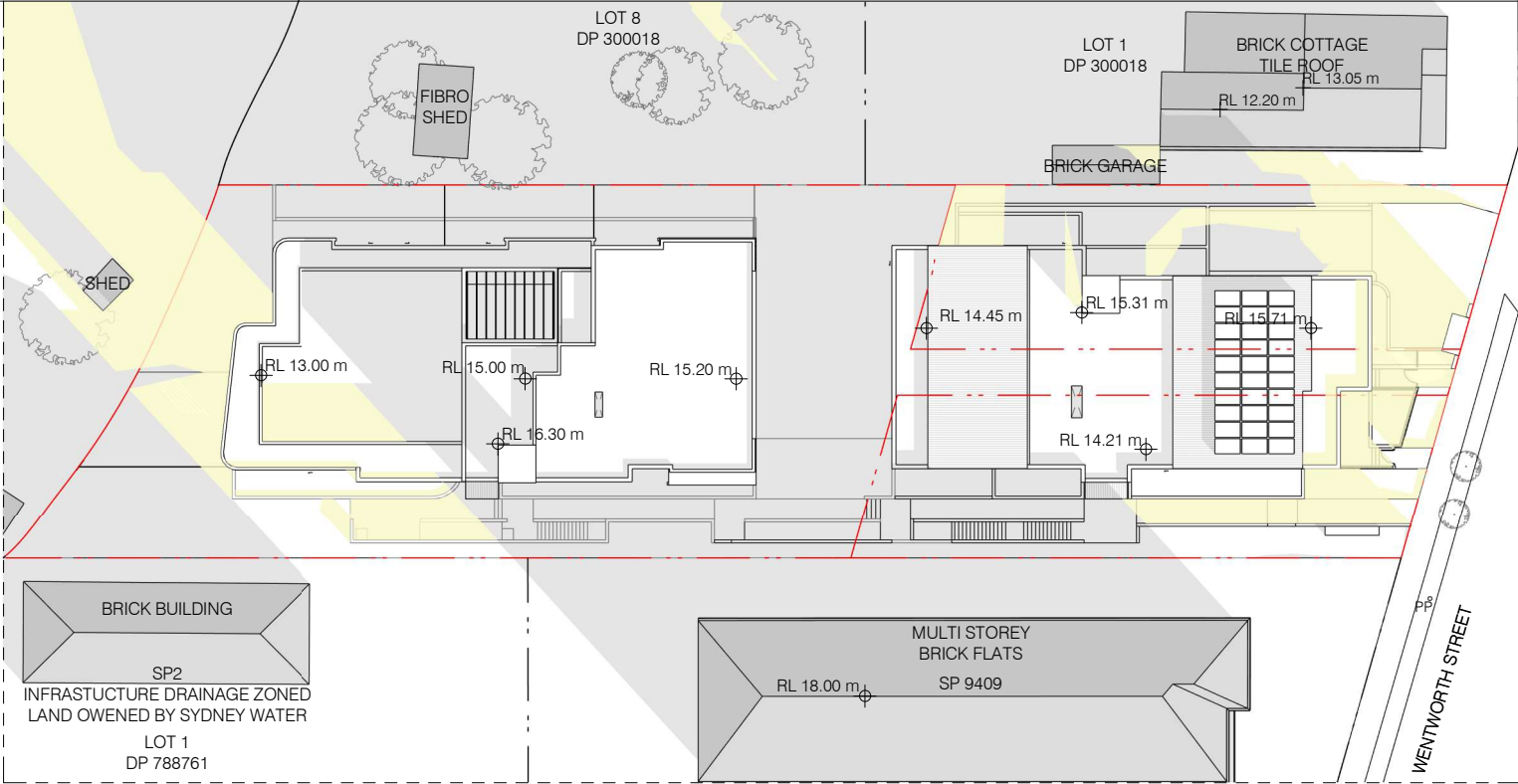

2 PROPOSED SHADOW DIAGRAM- JUNE 21- 8AM  
1 : 500

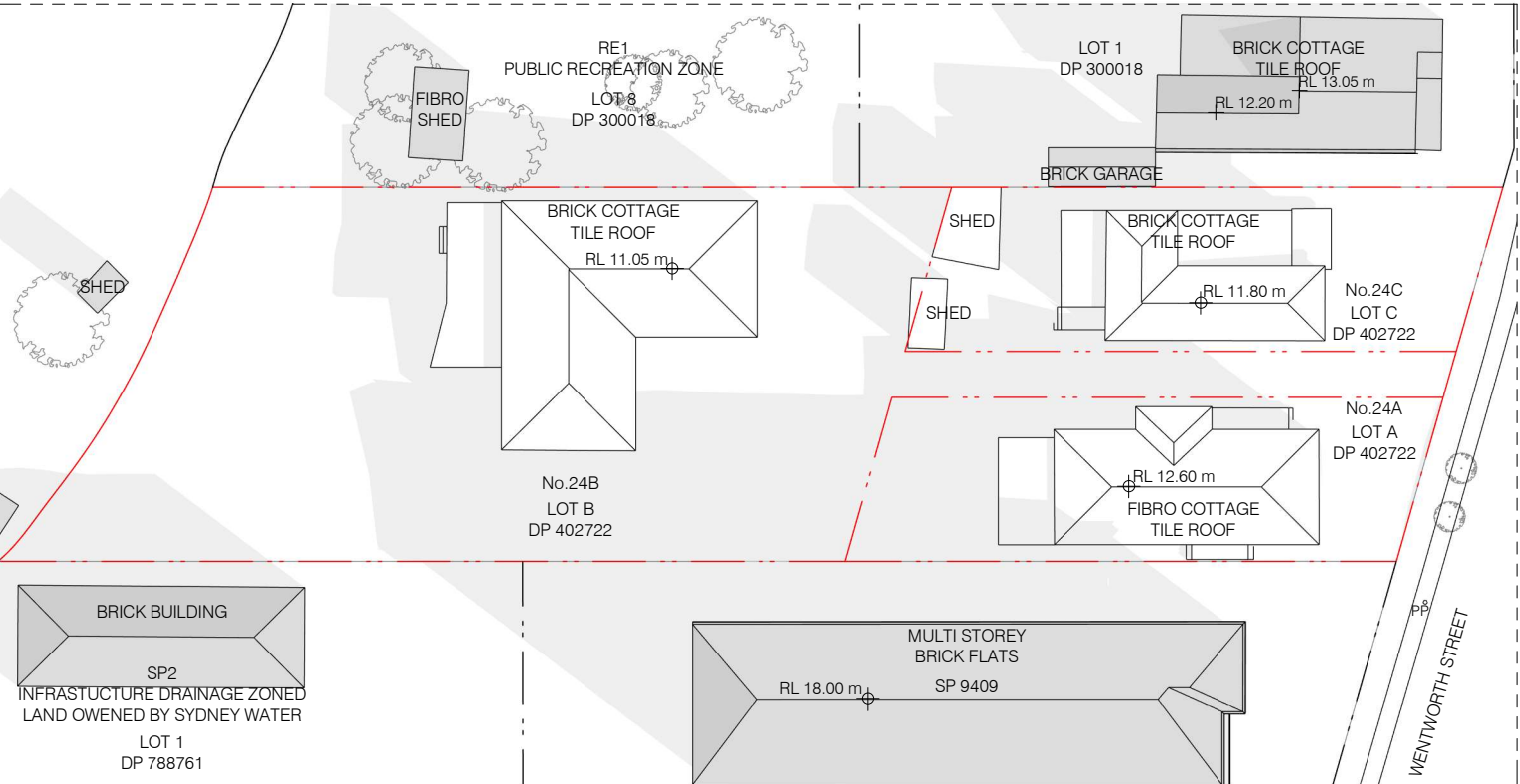

3 EXISTING SHADOW DIAGRAM- JUNE 21- 9AM  
1 : 500

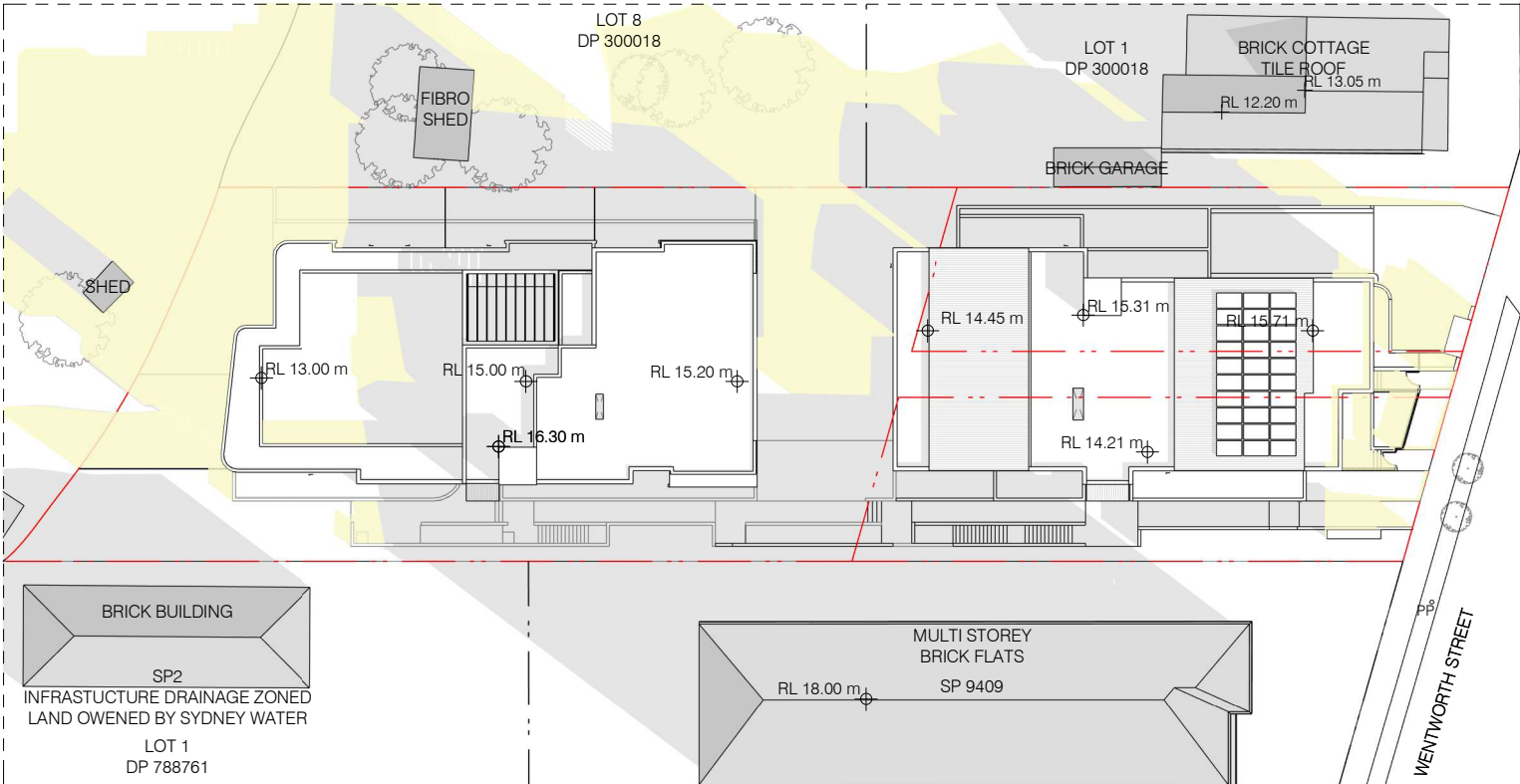

4 PROPOSED SHADOW DIAGRAM- JUNE 21- 9AM  
1 : 500

ARCHITECT		LENGEND		NORTH	ISSUE   AMENDMENT	
-----------	--	---------	--	-------	-------------------	--

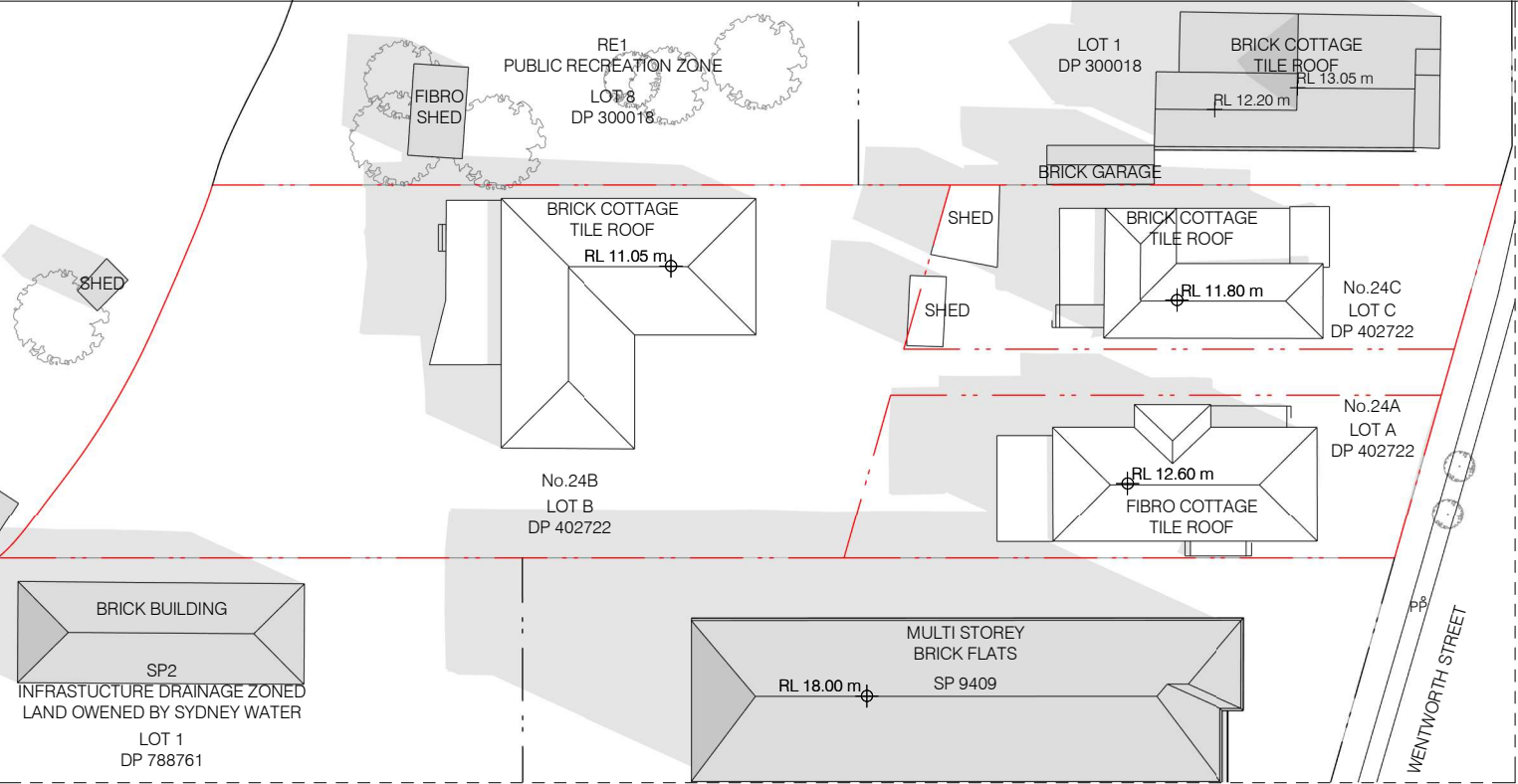

1 EXISTING SHADOW DIAGRAM- JUNE 21- 10AM  
1 : 500

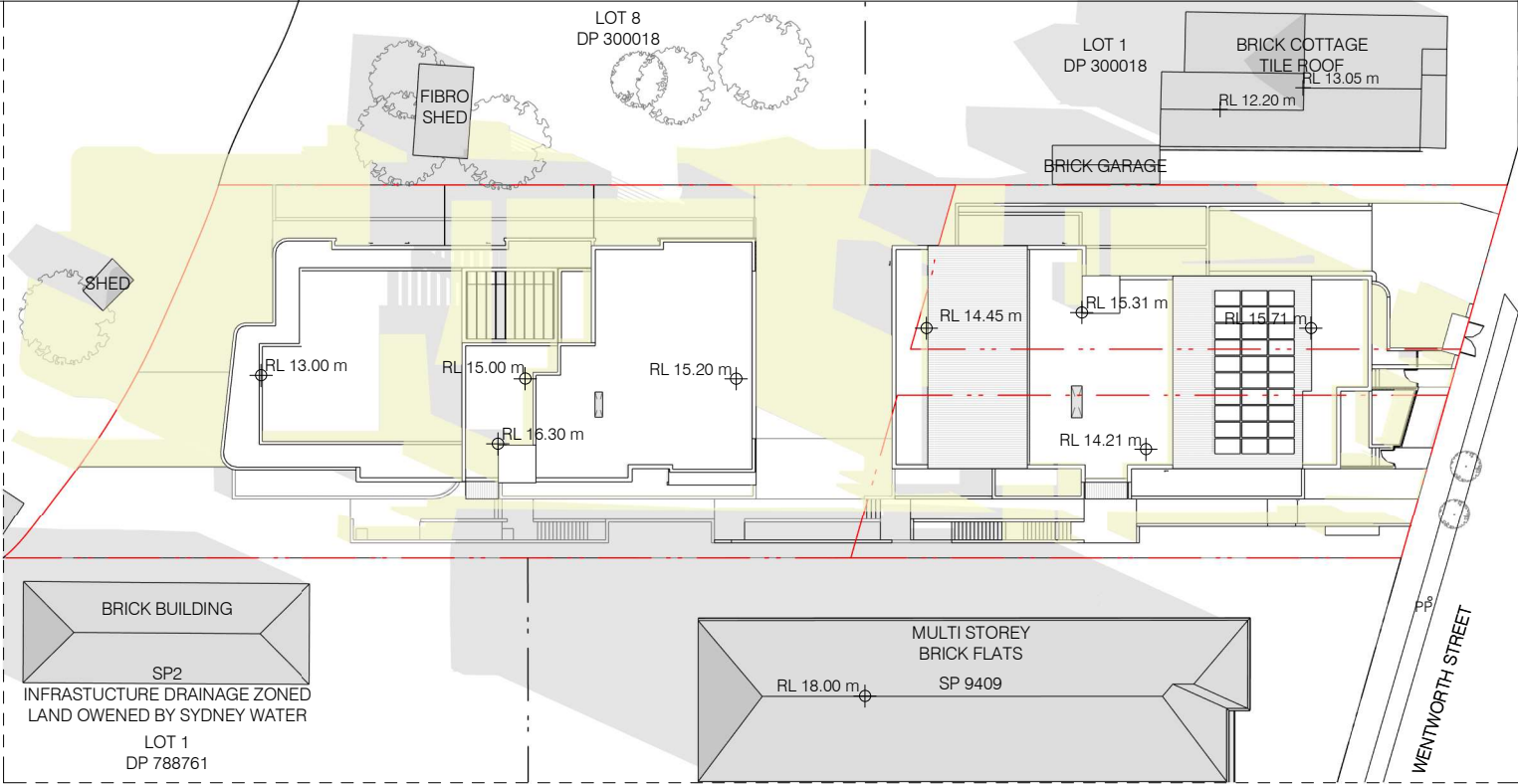

2 PROPOSED SHADOW DIAGRAM- JUNE 21- 10AM  
1 : 500

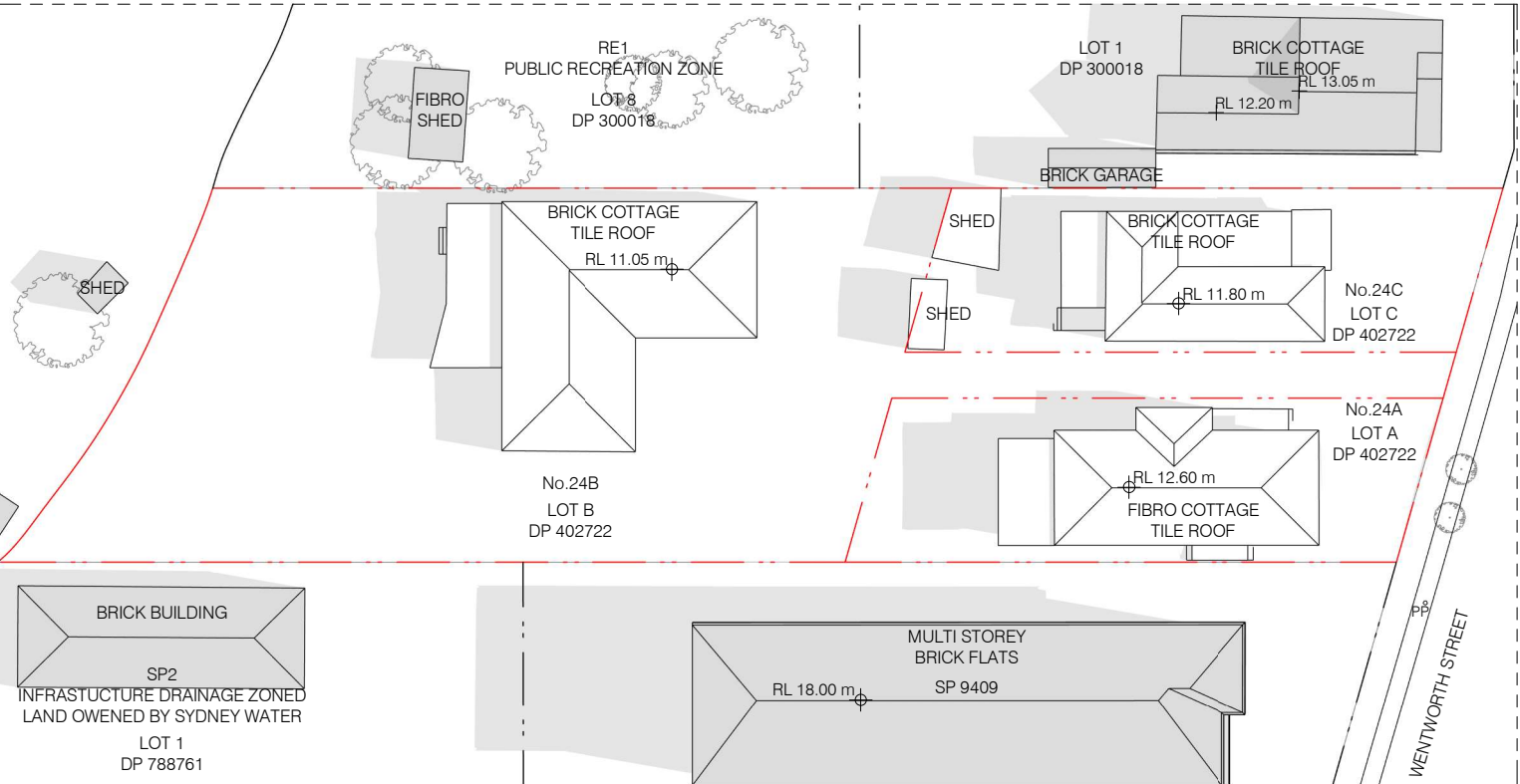

3 EXISTING SHADOW DIAGRAM- JUNE 21- 11AM  
1 : 500

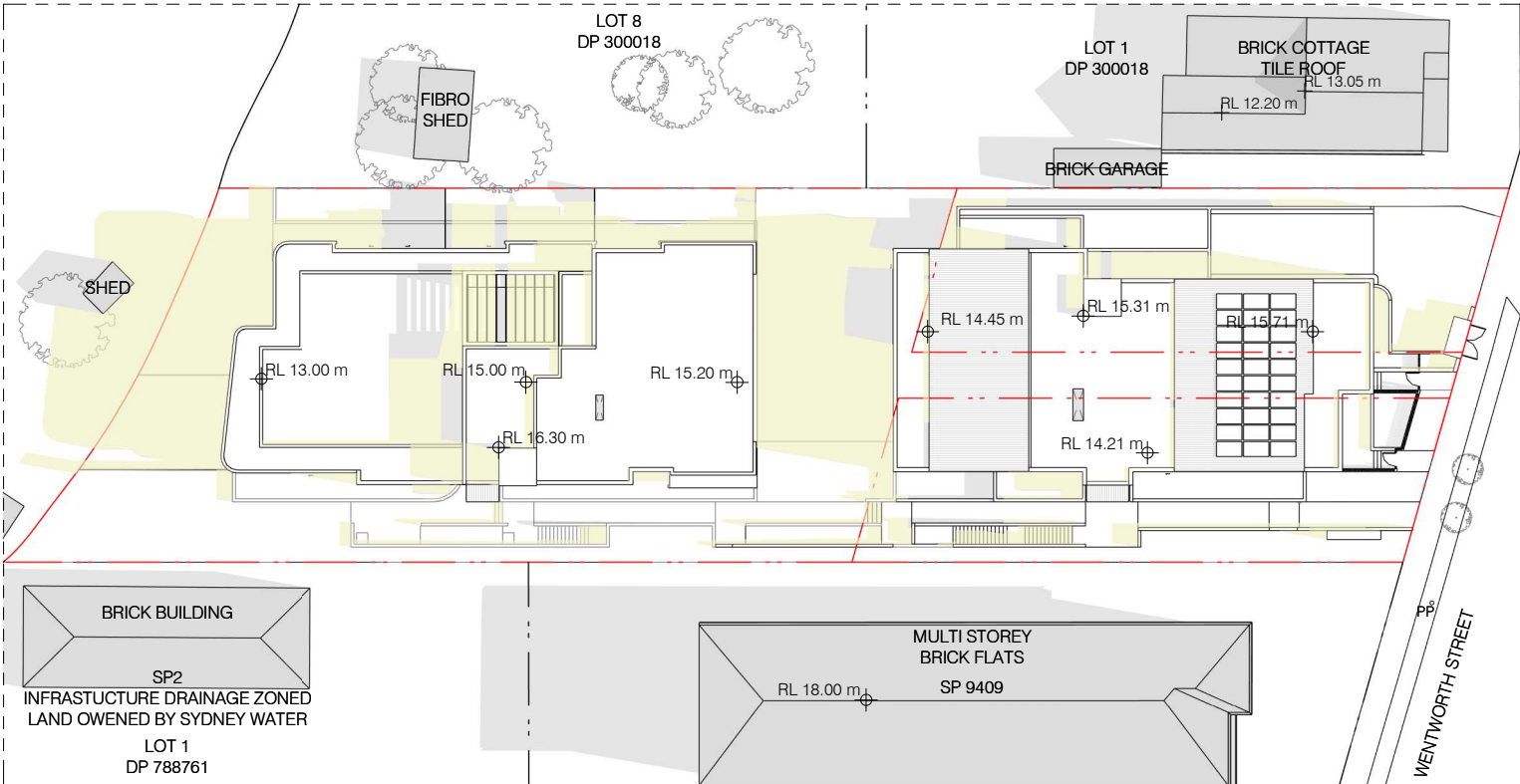

4 PROPOSED SHADOW DIAGRAM- JUNE 21- 11AM  
1 : 500



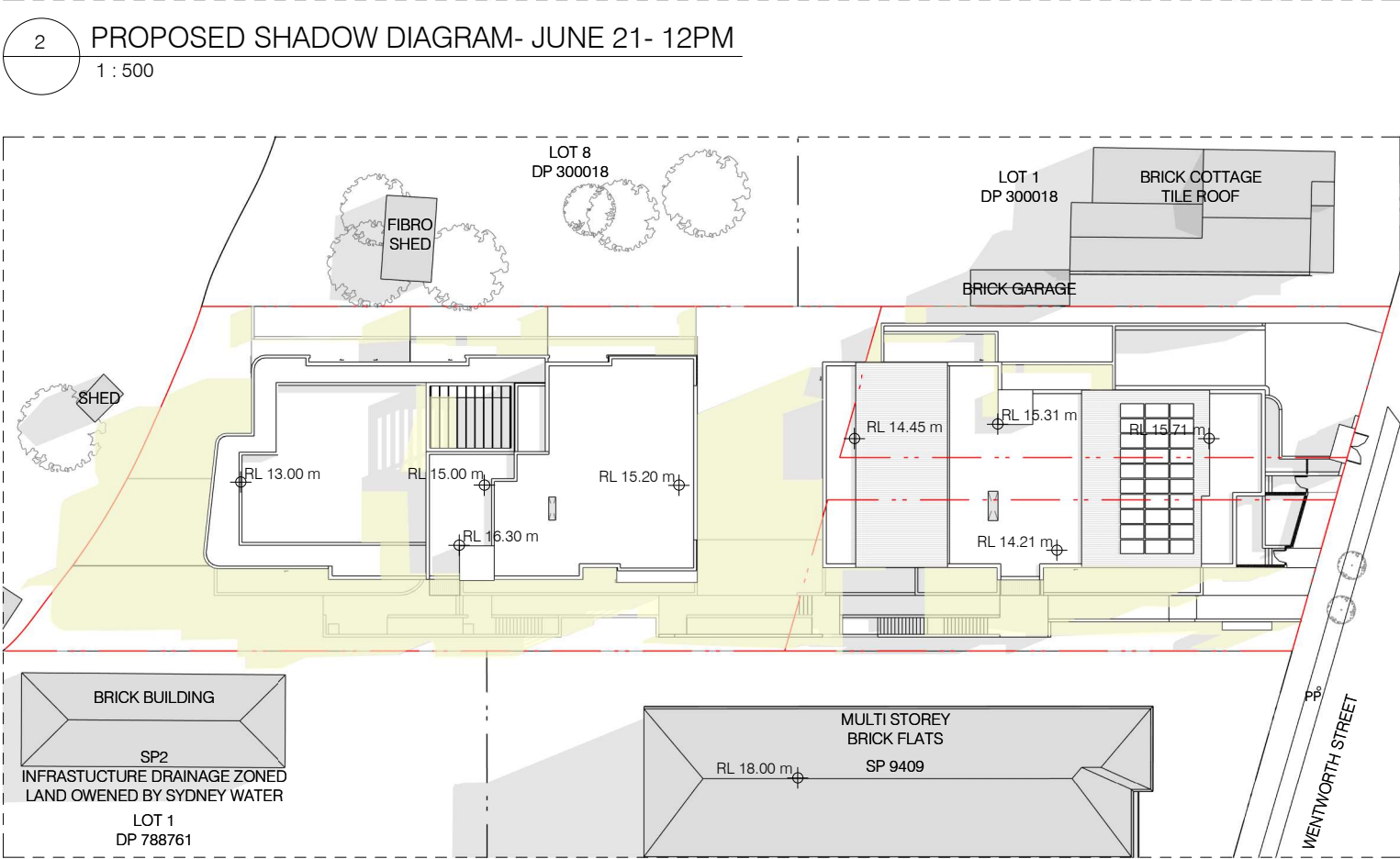
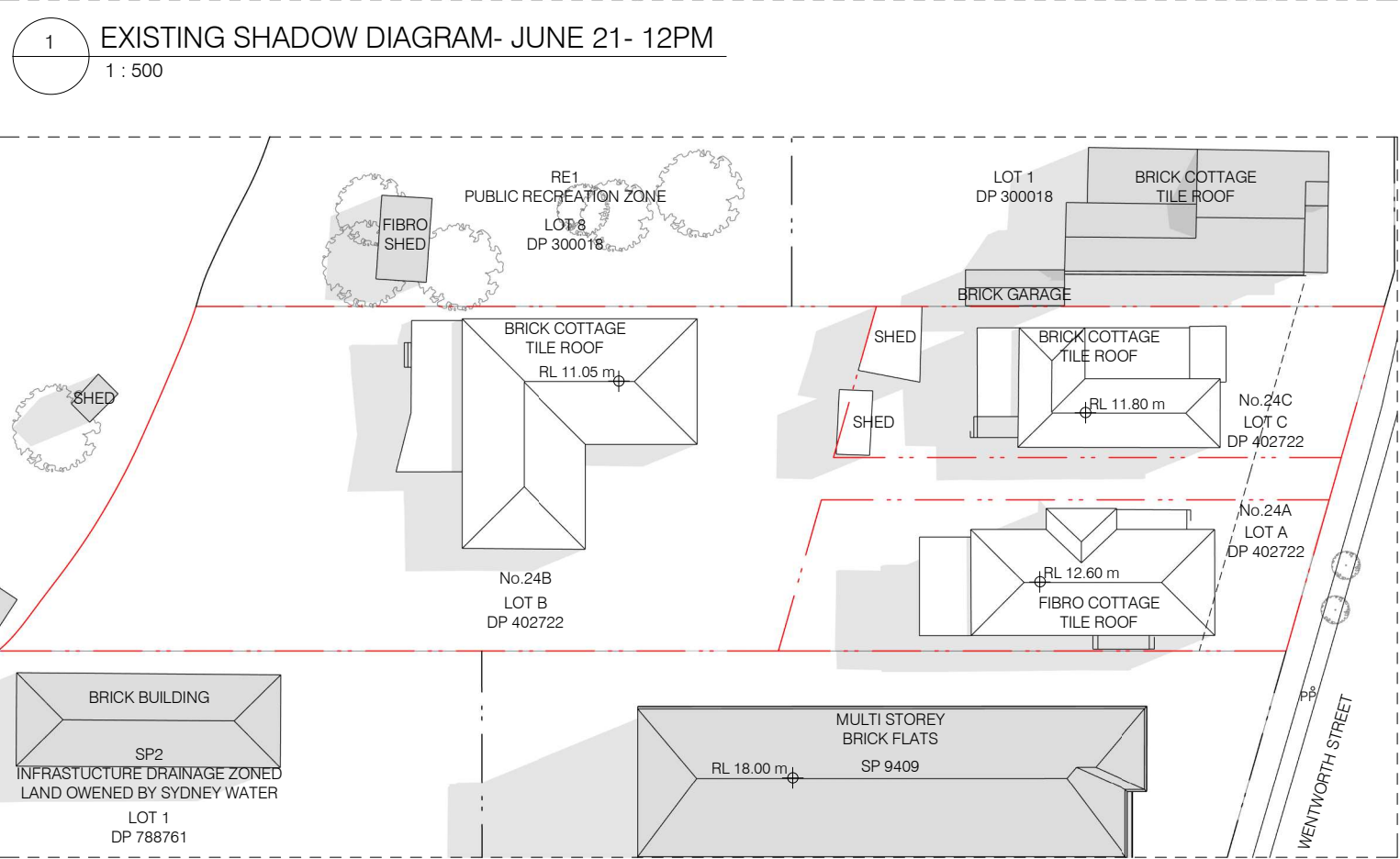
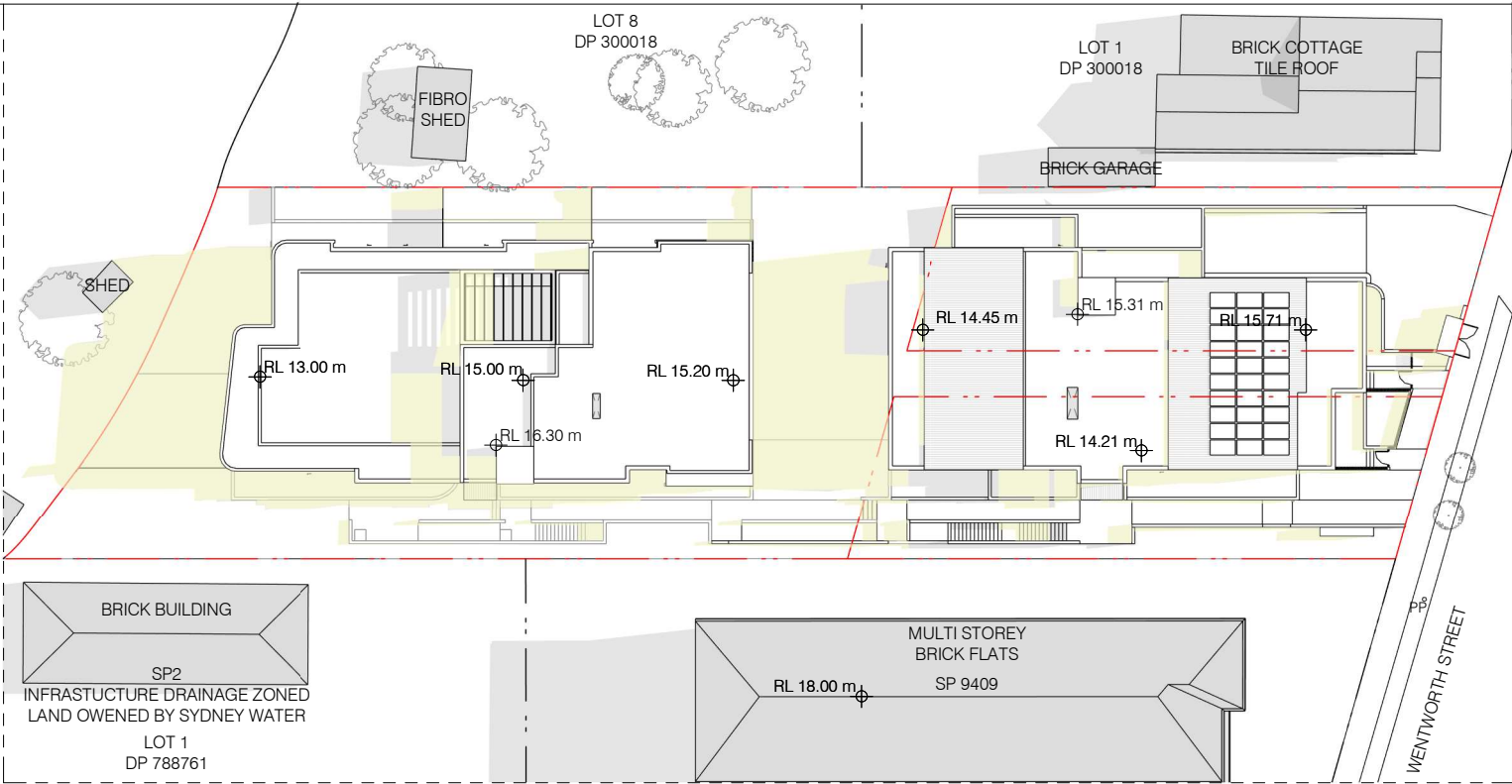
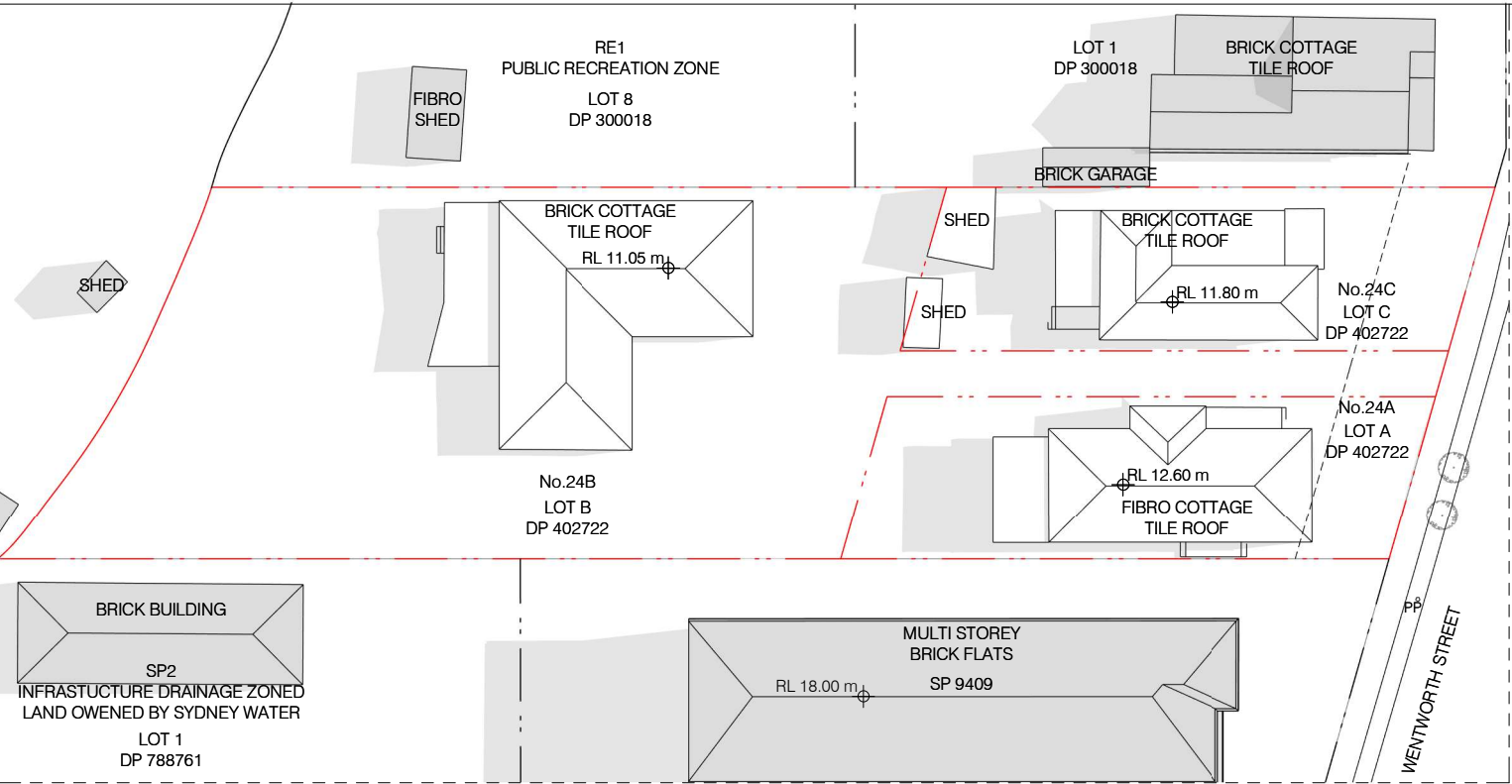

ARCHITECT

**B**

t: 02 8970 5417  
e: studio@bjbarchitects.com.au  
a: 3.09/77 Dunning Ave,  
Rosebery NSW 2018

BJB Architects Pty Ltd  
Nominated Architect:  
Barry Babikian NSW Reg No. 8806

LENGEND

EXISTING SHADOW

PROPOSED ADDITIONAL SHADOWS

NORTH

NORTH

ISSUE	AMENDMENT	DATE
A	ISSUED FOR DEVELOPMENT APPLICATION	28.11.2024

PROJECT

24A, 24B, 24C WENTWORTH ST, CROYDON PARK

NEW MULTI UNIT DWELLING DEVELOPMENT

SHADOW DIAGRAM - JUNE 21

SCALE: 1 : 500@ A3 DATE: 28.11.2024

ISSUE: A - ISSUED FOR DEVELOPMENT APPLICATION

2022-001

A1603

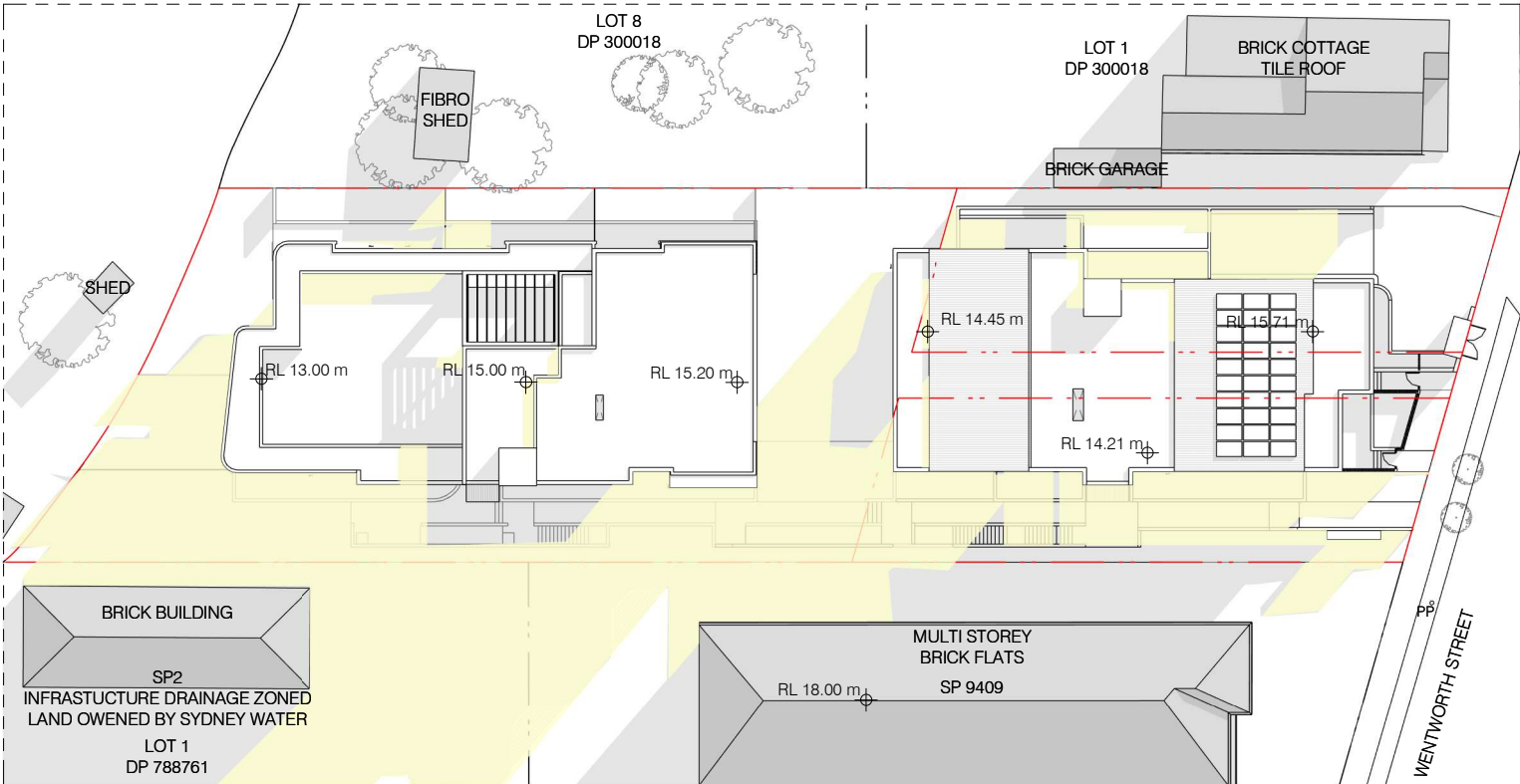
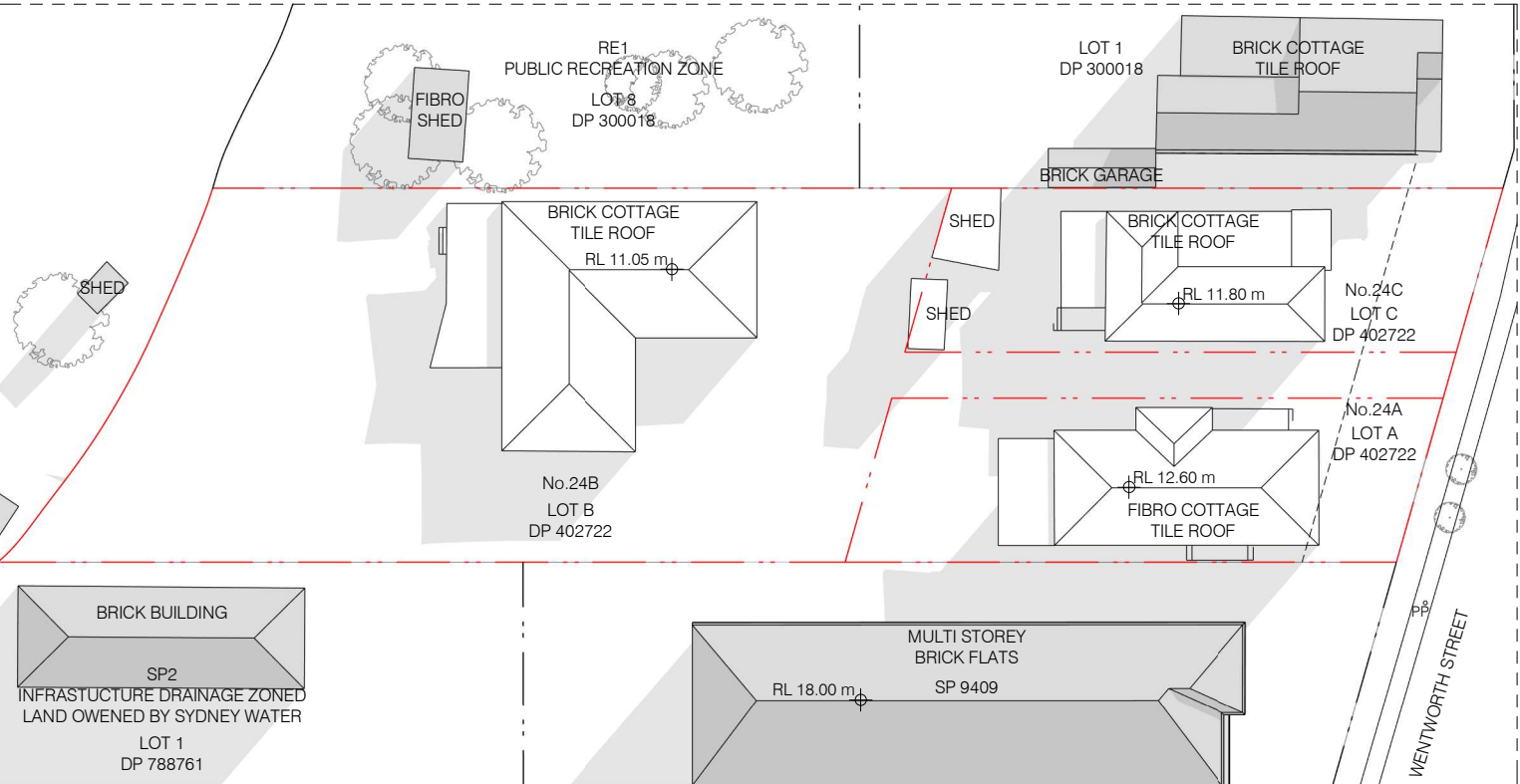
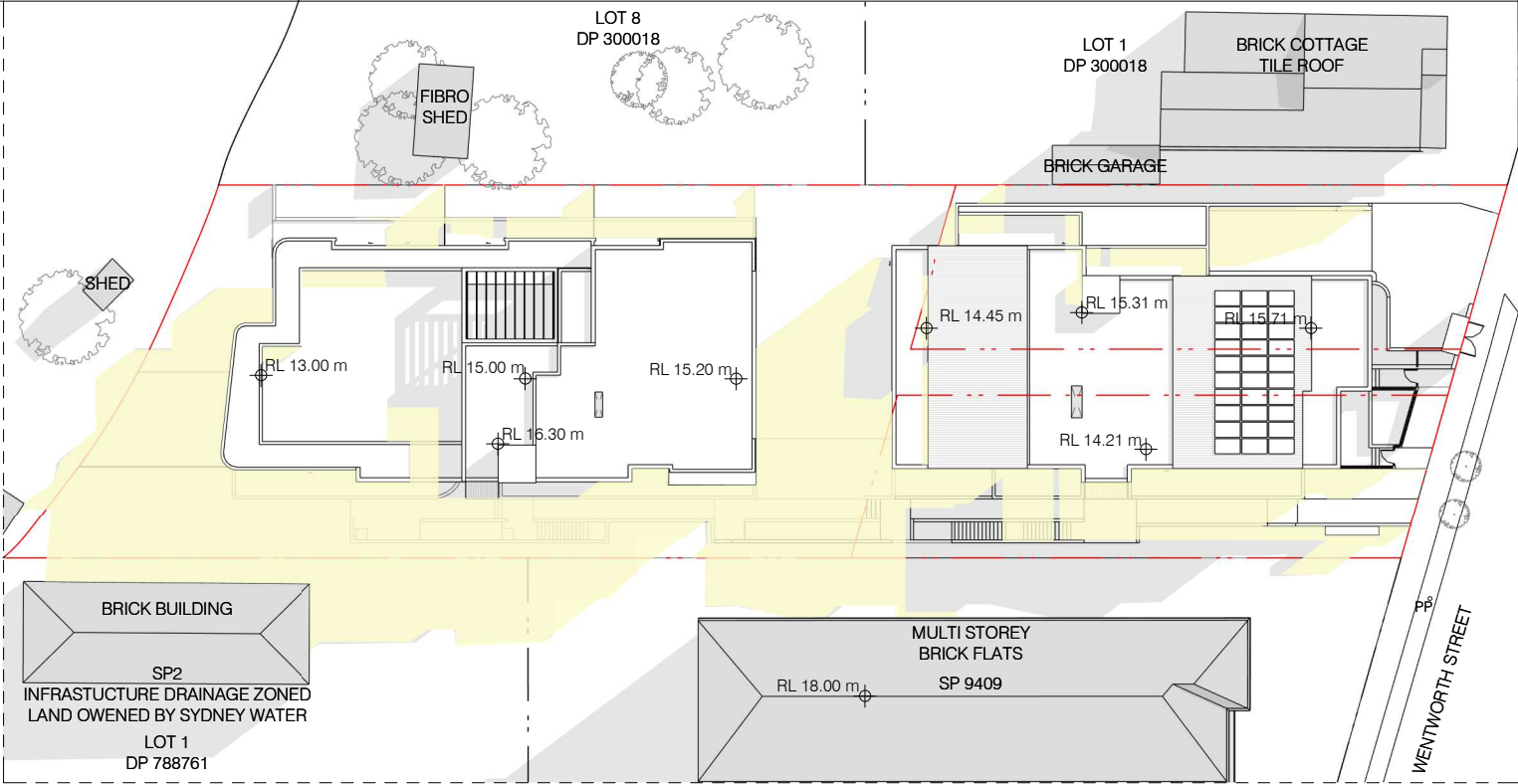
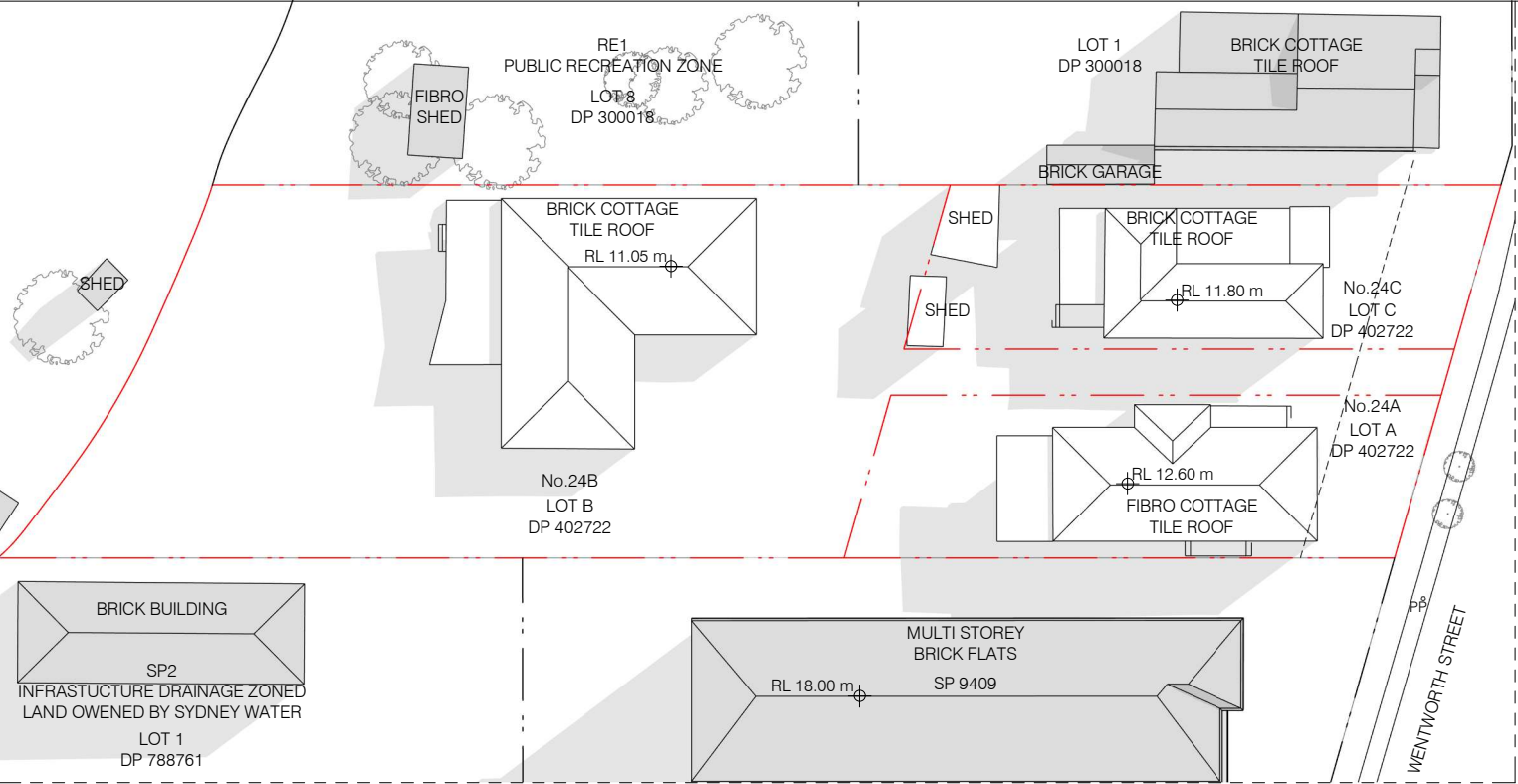

<p>ARCHITECT</p> <p><b>B B</b></p> <p>t: 02 8970 5417 e: studio@bjbarchitects.com.au a: 3.09/77 Dunning Ave, Rosebery NSW 2018</p> <p>BJB Architects Pty Ltd Nominated Architect: Barry Babikian NSW Reg No. 8806</p>	<p>LENGEND</p> <p>EXISTING SHADOW</p> <p>PROPOSED ADDITIONAL SHADOWS</p>	<p>NORTH</p> <p>NORTH</p>	<table><tr><th>ISSUE</th><th>AMENDMENT</th><th>DATE</th></tr><tr><td>A</td><td>ISSUED FOR DEVELOPMENT APPLICATION</td><td>28.11.2024</td></tr></table>	ISSUE	AMENDMENT	DATE	A	ISSUED FOR DEVELOPMENT APPLICATION	28.11.2024	<p>PROJECT</p> <p>24A, 24B, 24C WENTWORTH ST, CROYDON PARK</p> <p>NEW MULTI UNIT DWELLING DEVELOPMENT</p>	<p>SHADOW DIAGRAM - JUNE 21</p> <p>SCALE: 1 : 500@ A3 DATE: 28.11.2024</p> <p>ISSUE: A - ISSUED FOR DEVELOPMENT APPLICATION</p> <p>2022-001</p> <p>A1604</p>
ISSUE	AMENDMENT	DATE									
A	ISSUED FOR DEVELOPMENT APPLICATION	28.11.2024									



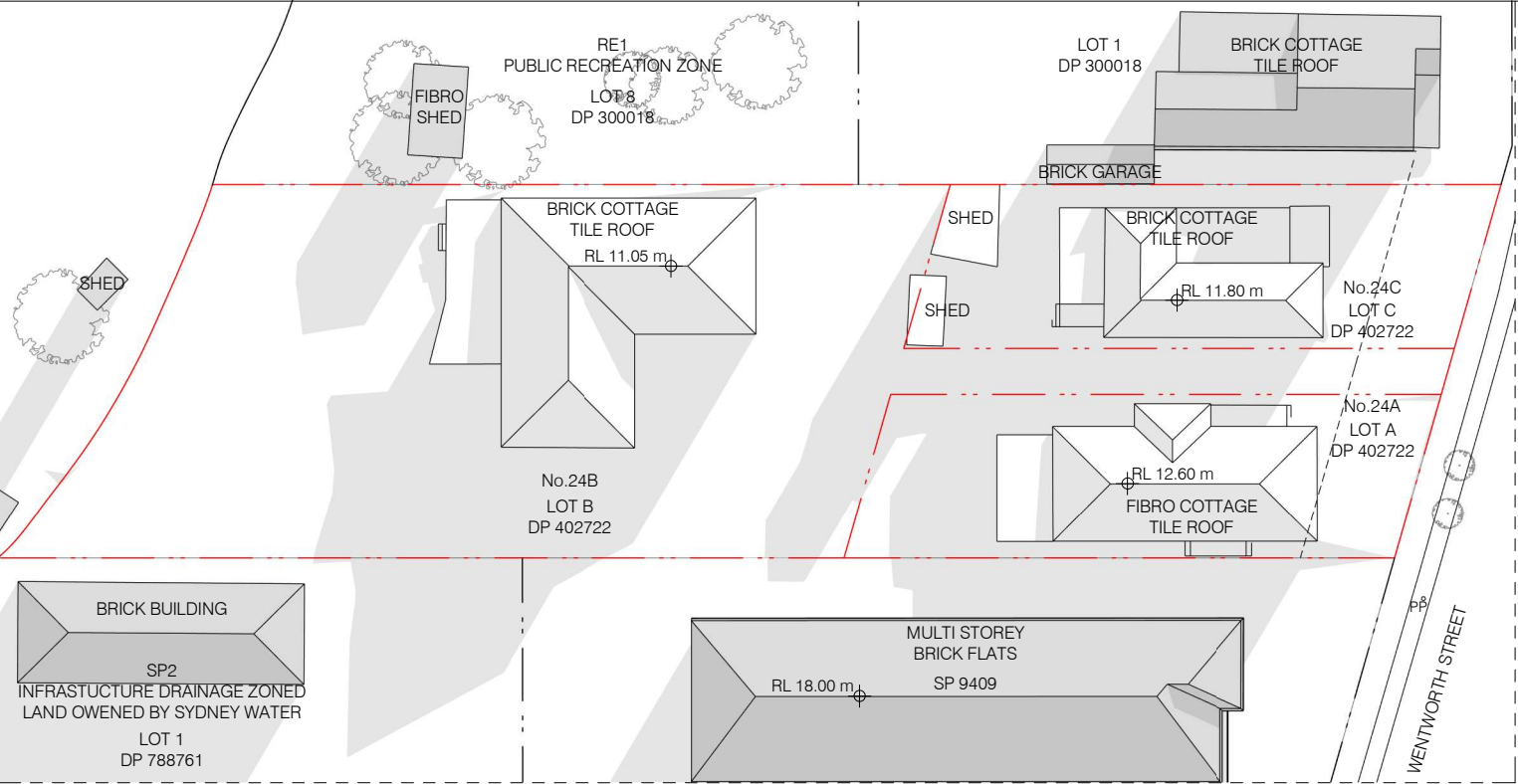

1 EXISTING SHADOW DIAGRAM- JUNE 21- 4PM  
1 : 500

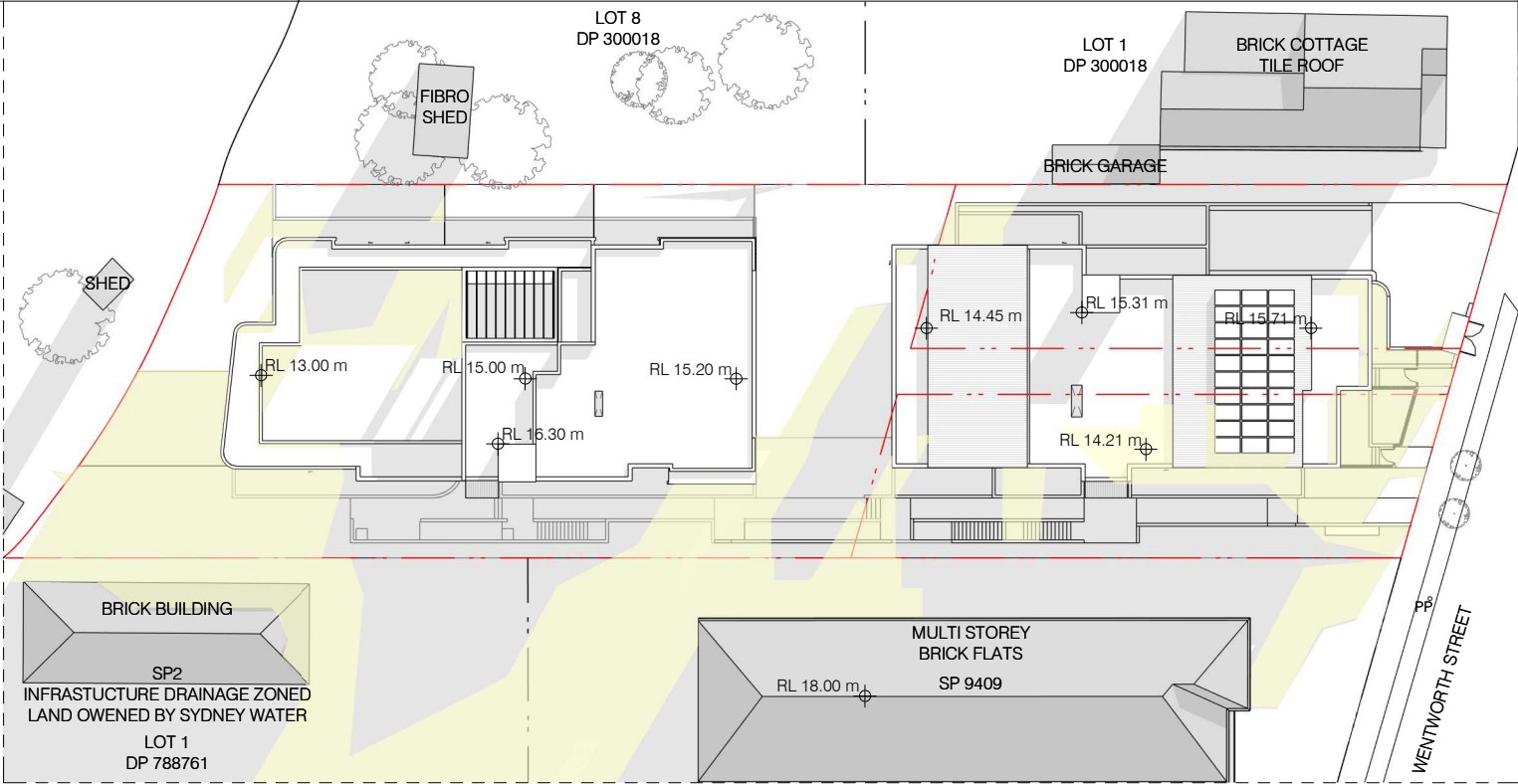

2 PROPOSED SHADOW DIAGRAM- JUNE 21- 4PM  
1 : 500

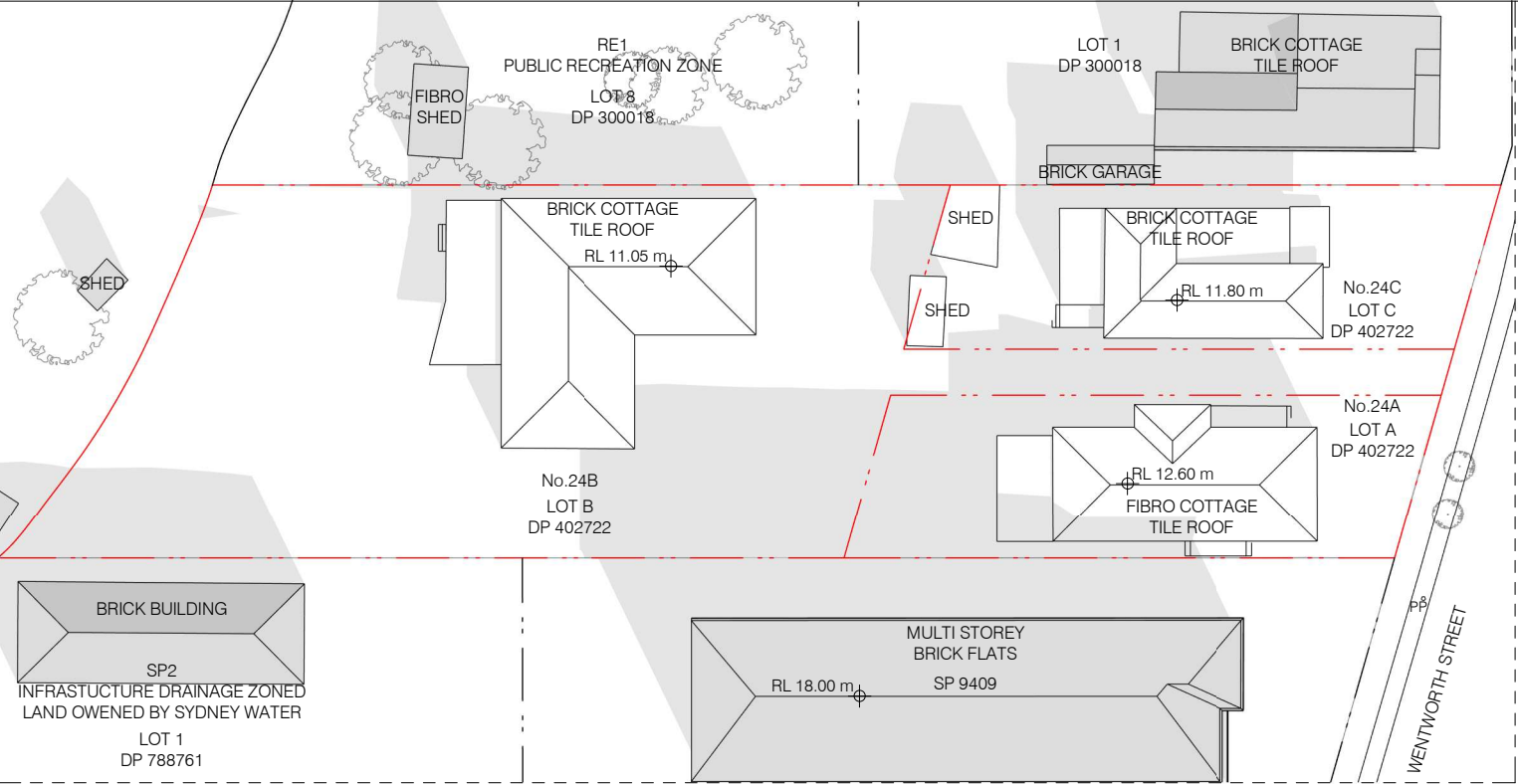

1 EXISTING SHADOW DIAGRAM-SEPTEMBER 22- 8AM  
1 : 500

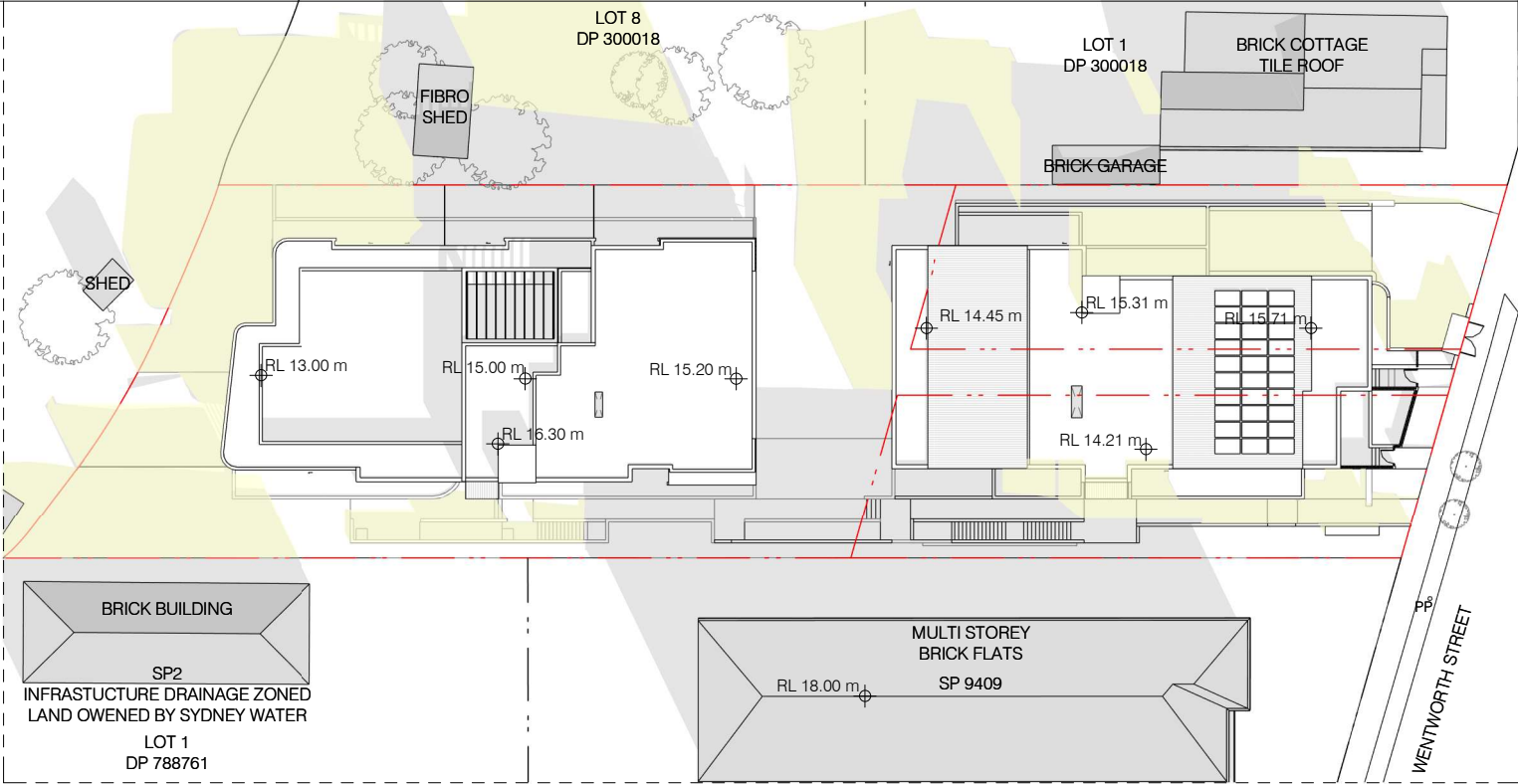

2 PROPOSED SHADOW DIAGRAM-SEPTEMBER 22- 8AM  
1 : 500

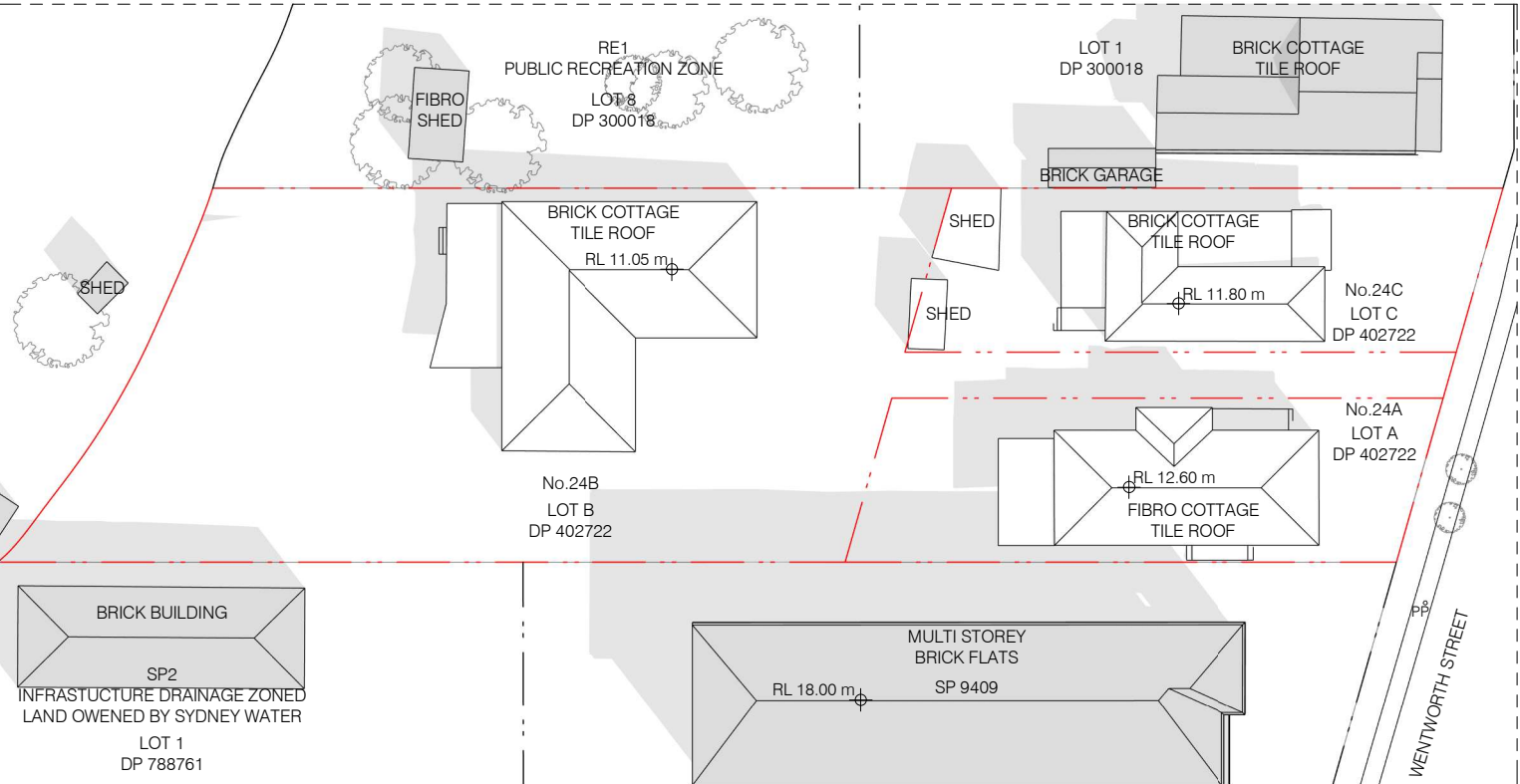

3 EXISTING SHADOW DIAGRAM-SEPTEMBER 22- 9AM  
1 : 500

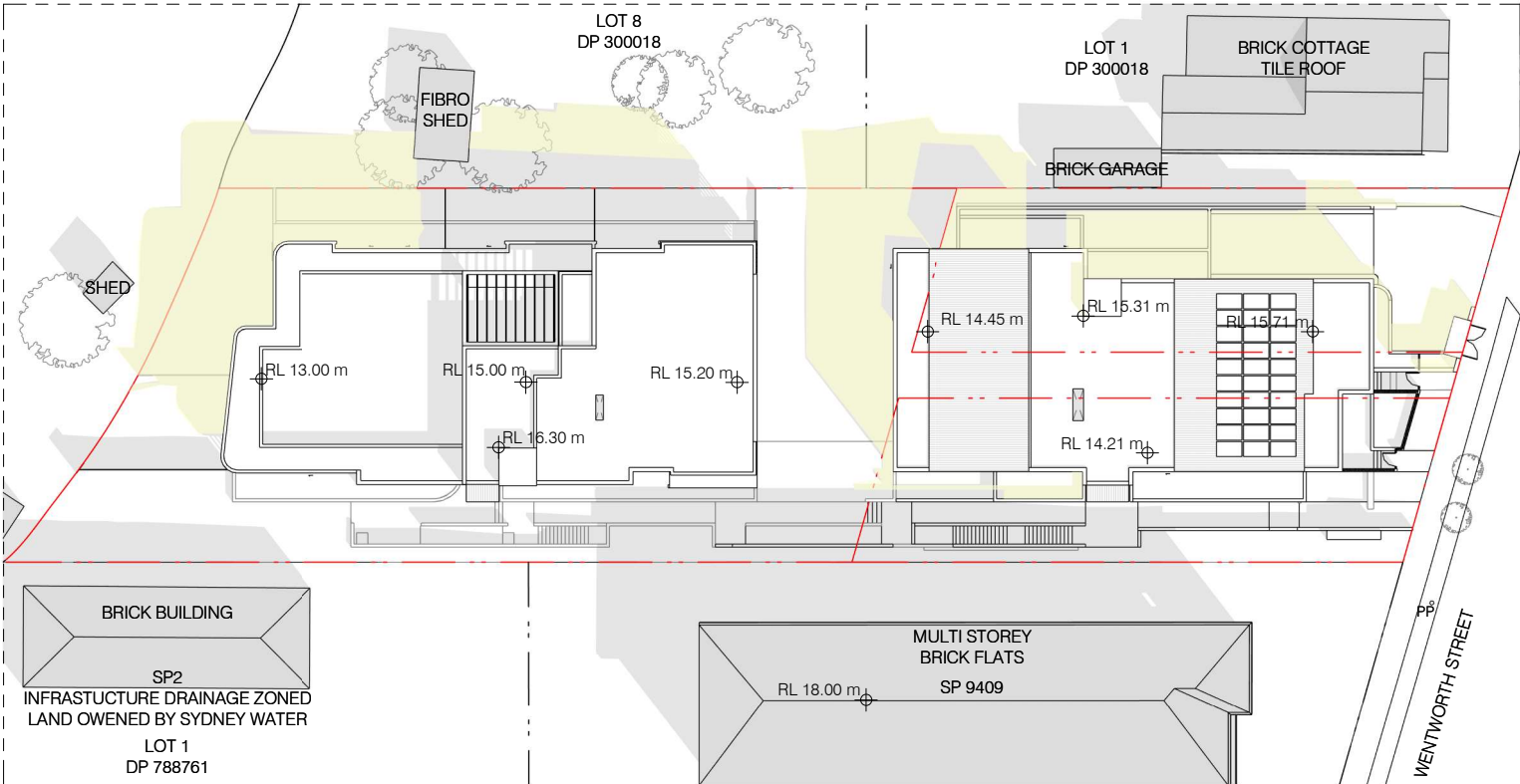

4 PROPOSED SHADOW DIAGRAM-SEPTEMBER 22- 9AM  
1 : 500

ARCHITECT



t: 02 8970 5417  
e: studio@bjbarchitects.com.au  
a: 3.09/77 Dunning Ave,  
Rosebery NSW 2018

BJB Architects Pty Ltd  
Nominated Architect:  
Barry Babikian NSW Reg No. 8806

LENGEND

 EXISTING SHADOW

 PROPOPOSED ADDITIONAL SHADOWS

NORTH

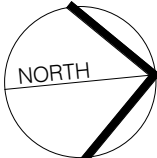

ISSUE	AMENDMENT	DATE
A	ISSUED FOR DEVELOPMENT APPLICATION	28.11.2024

PROJECT

24A, 24B, 24C WENTWORTH ST, CROYDON PARK

NEW MULTI UNIT DWELLING DEVELOPMENT

SHADOW DIAGRAM - SEPTEMBER 22

SCALE: N.T.S.      DATE: 28.11.2024

ISSUE: A - ISSUED FOR DEVELOPMENT APPLICATION

THIS DOCUMENT IS THE COPYRIGHT OF BJB ARCHITECTS. ALL INFORMATION ILLUSTRATED ON THIS DOCUMENT IS TO BE CHECKED AND VERIFIED ON SITE. IN THE EVENT OF DISCREPANCIES REFER TO BJB ARCHITECTS PRIOR TO COMMENCEMENT OF THE WORK. DO NOT SCALE DRAWINGS MANUALLY OR ELECTRONICALLY

2022-001

A1610



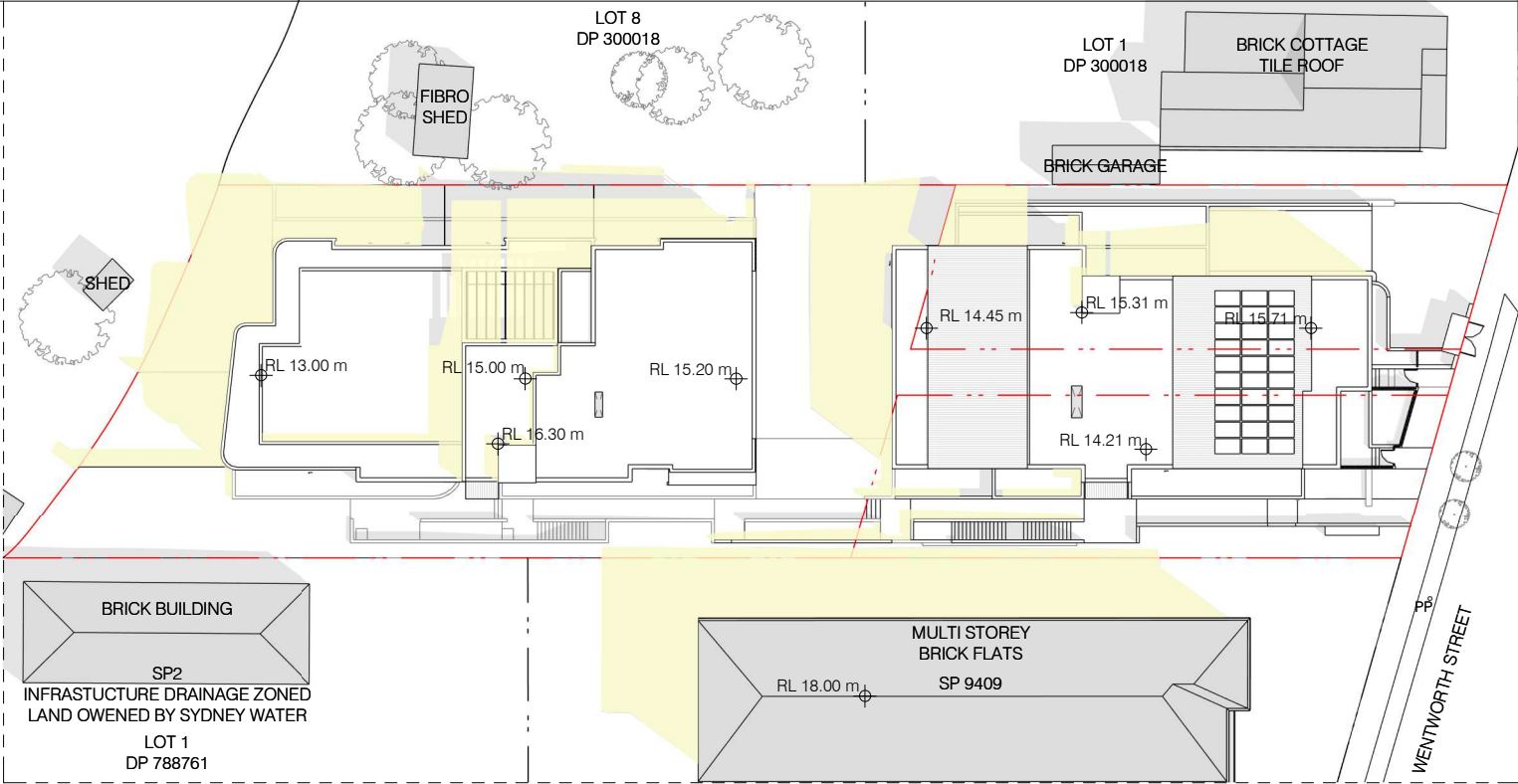
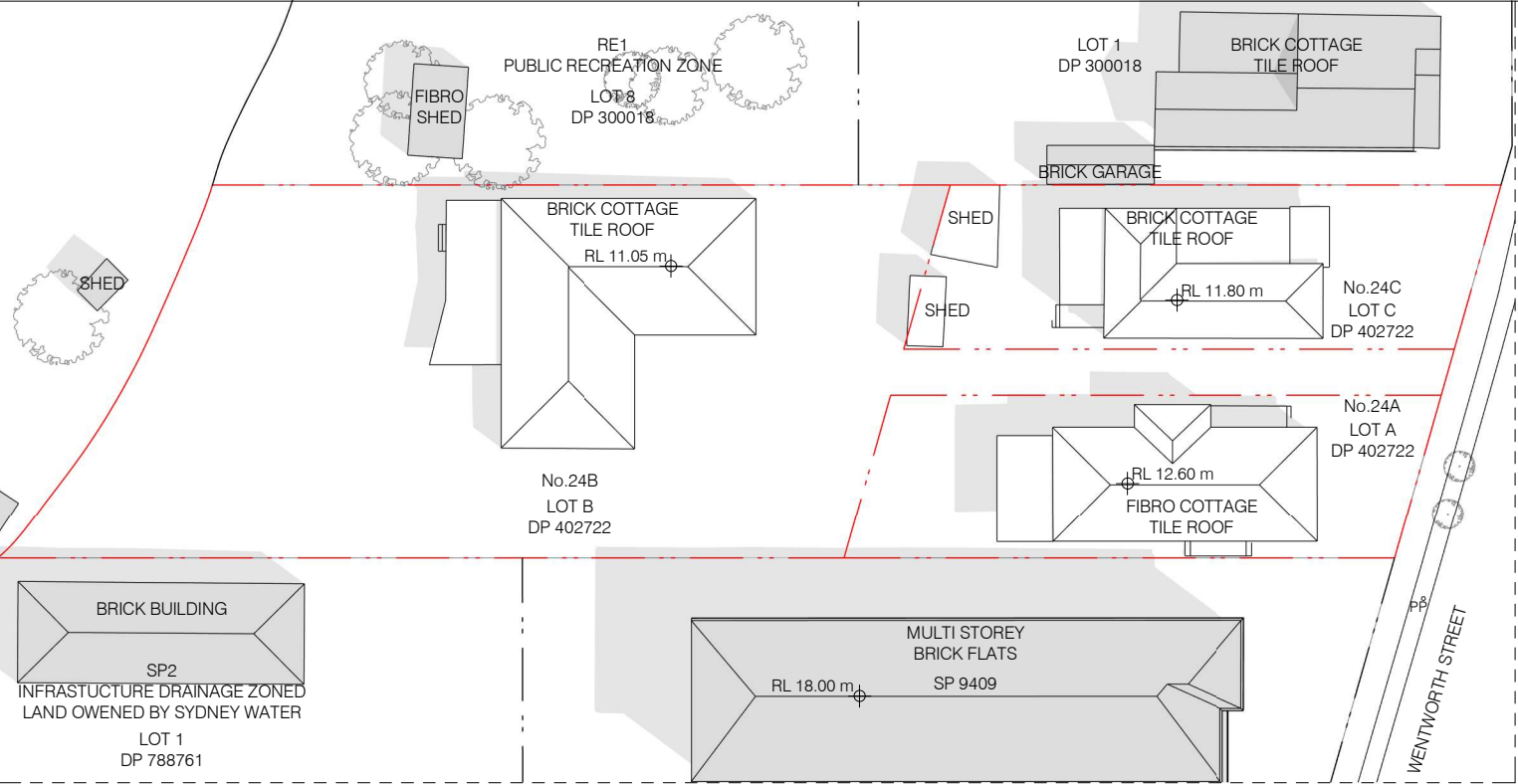

1 EXISTING SHADOW DIAGRAM-SEPTEMBER 22- 10AM  
1 : 500

2 PROPOSED SHADOW DIAGRAM-SEPTEMBER 22- 10AM  
1 : 500

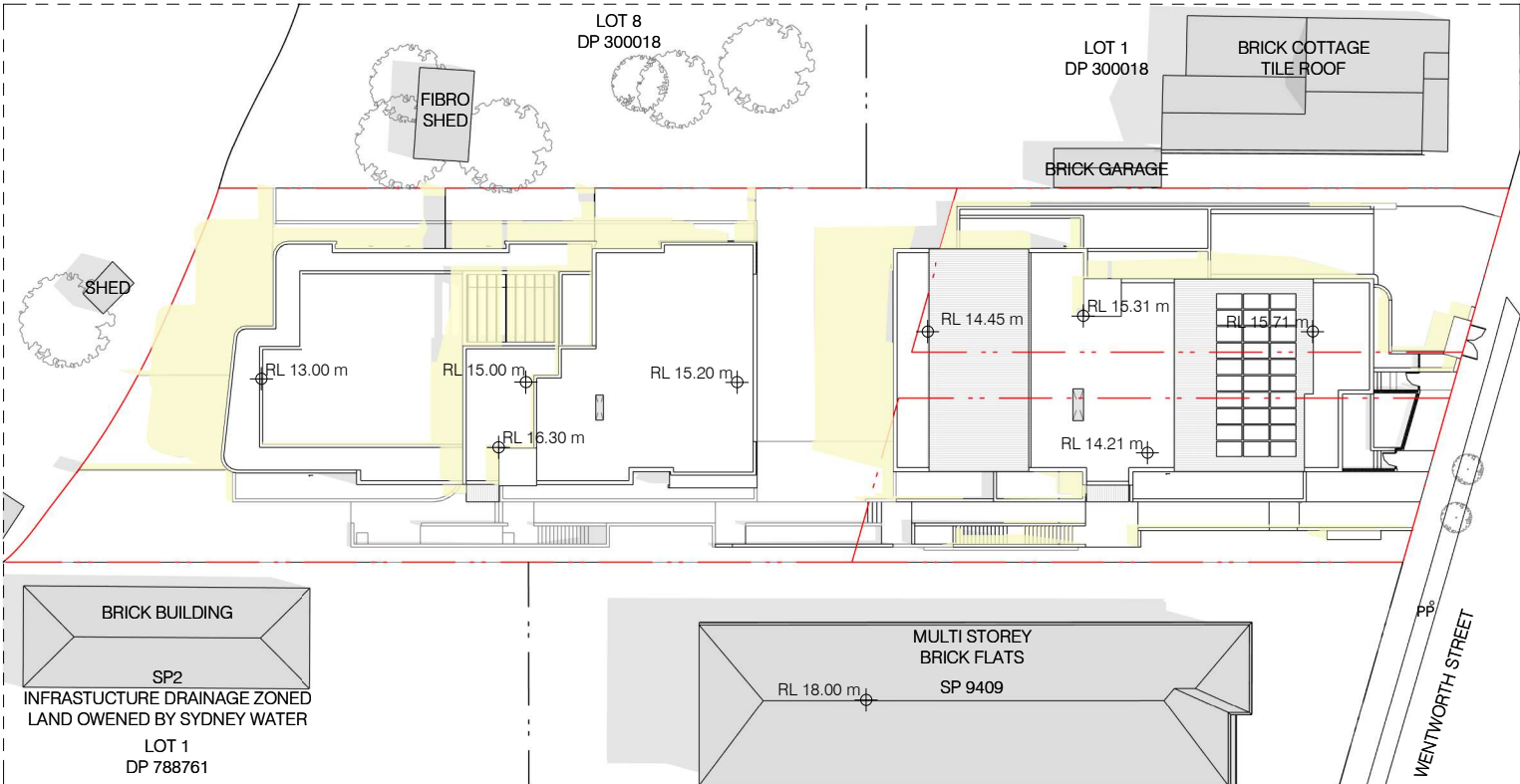
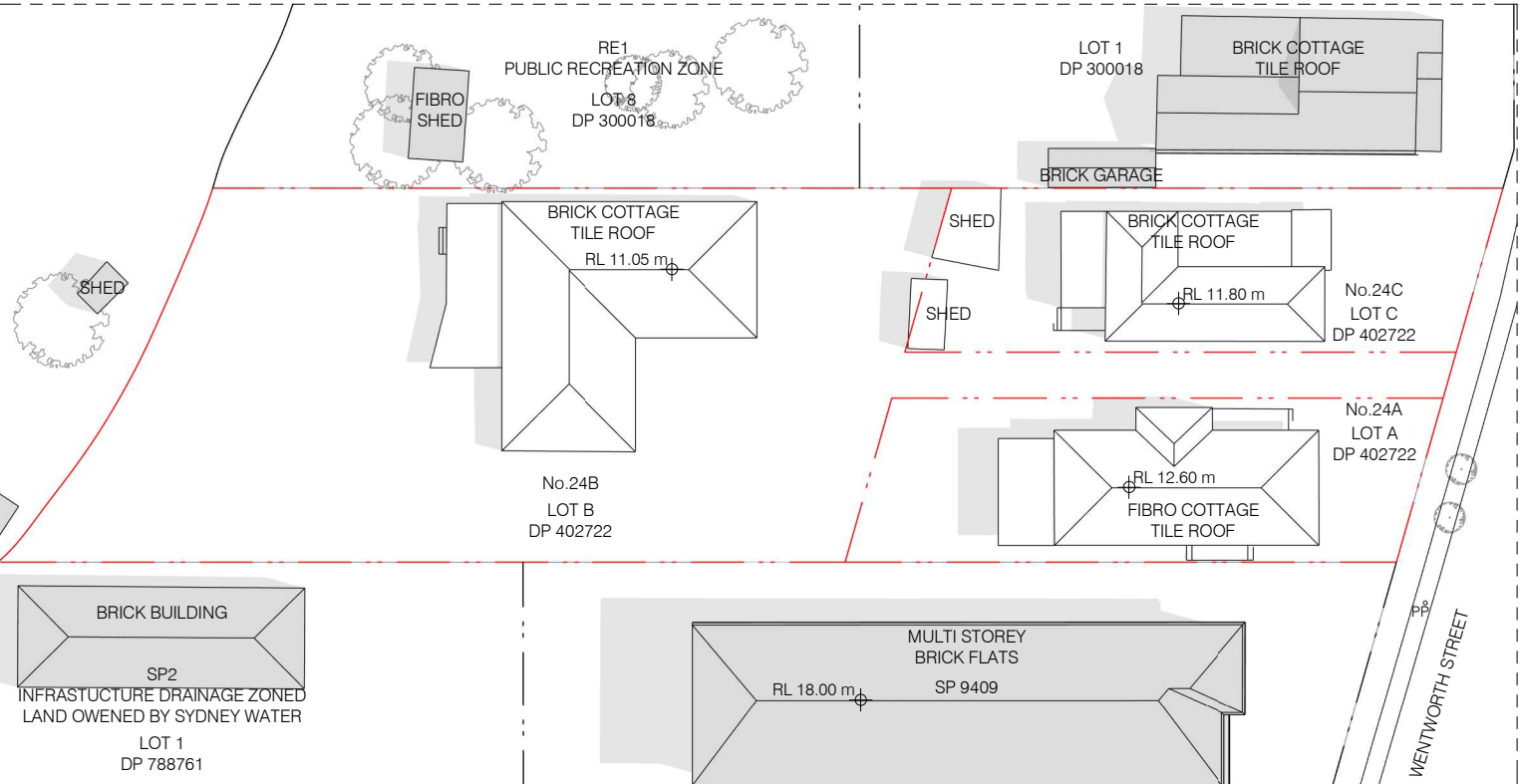

3 EXISTING SHADOW DIAGRAM-SEPTEMBER 22- 11AM  
1 : 500

4 PROPOSED SHADOW DIAGRAM-SEPTEMBER 22- 11AM  
1 : 500

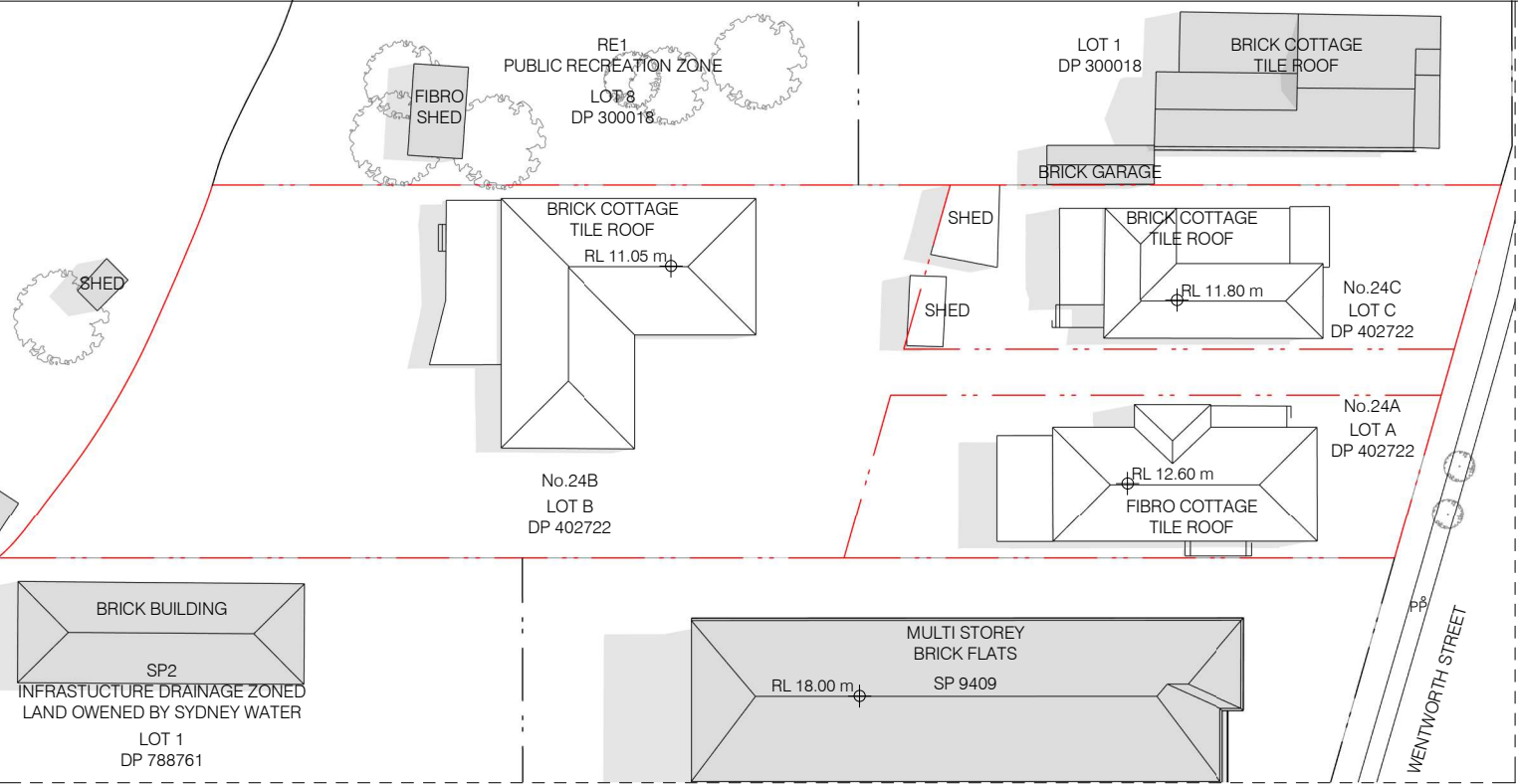

1 EXISTING SHADOW DIAGRAM-SEPTEMBER 22- 12PM  
1 : 500

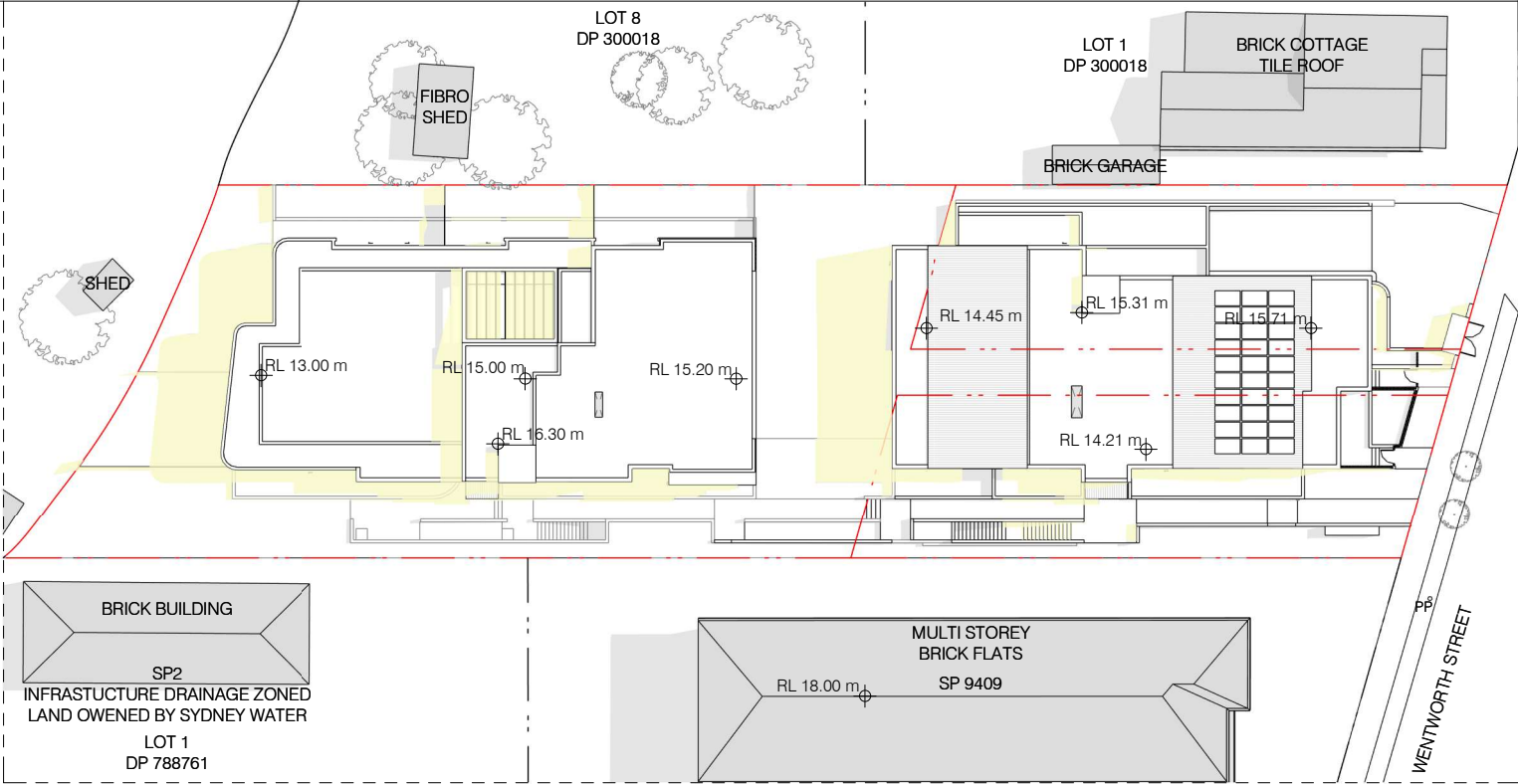

2 PROPOSED SHADOW DIAGRAM-SEPTEMBER 22- 12PM  
1 : 500

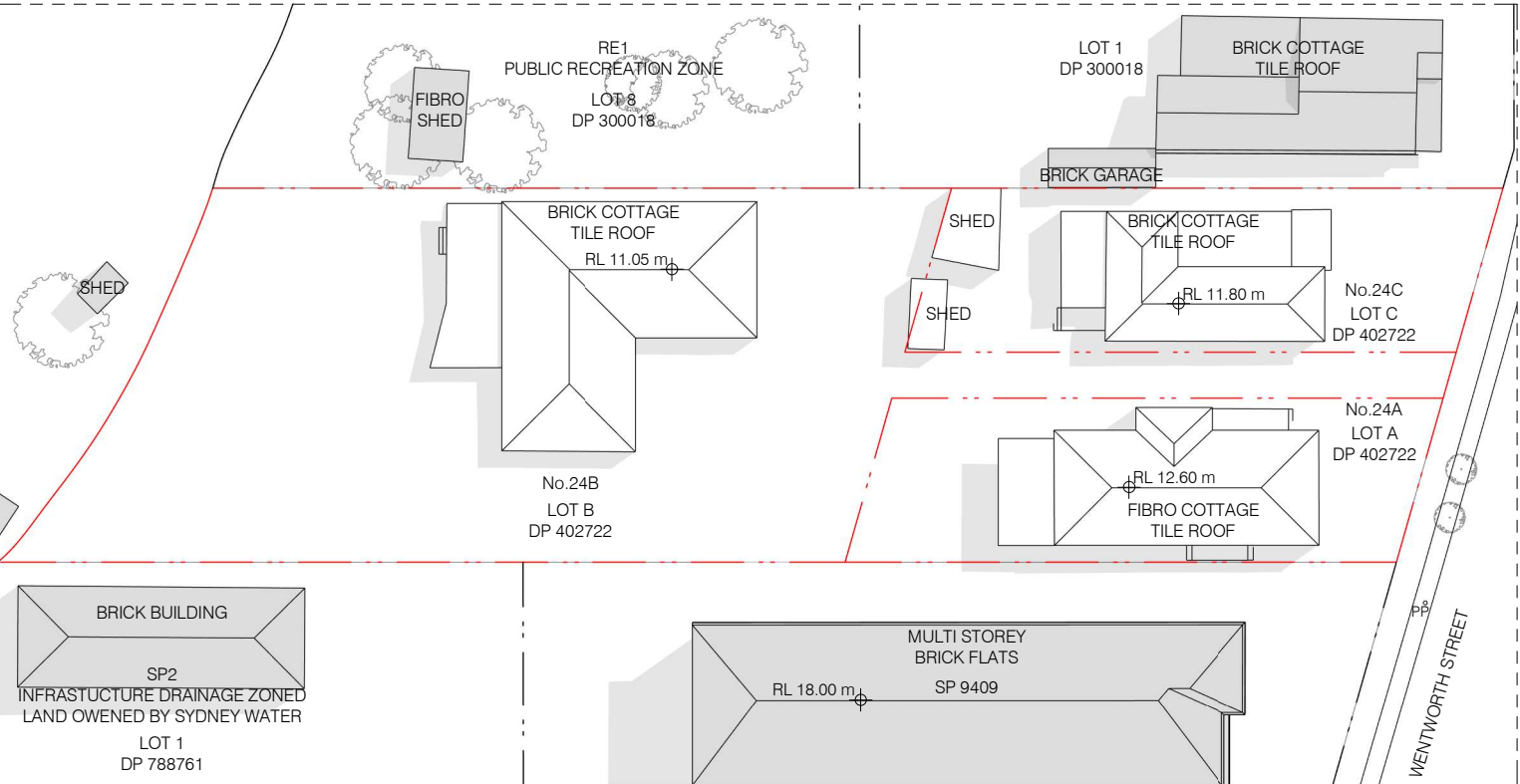

3 EXISTING SHADOW DIAGRAM-SEPTEMBER 22- 1PM  
1 : 500

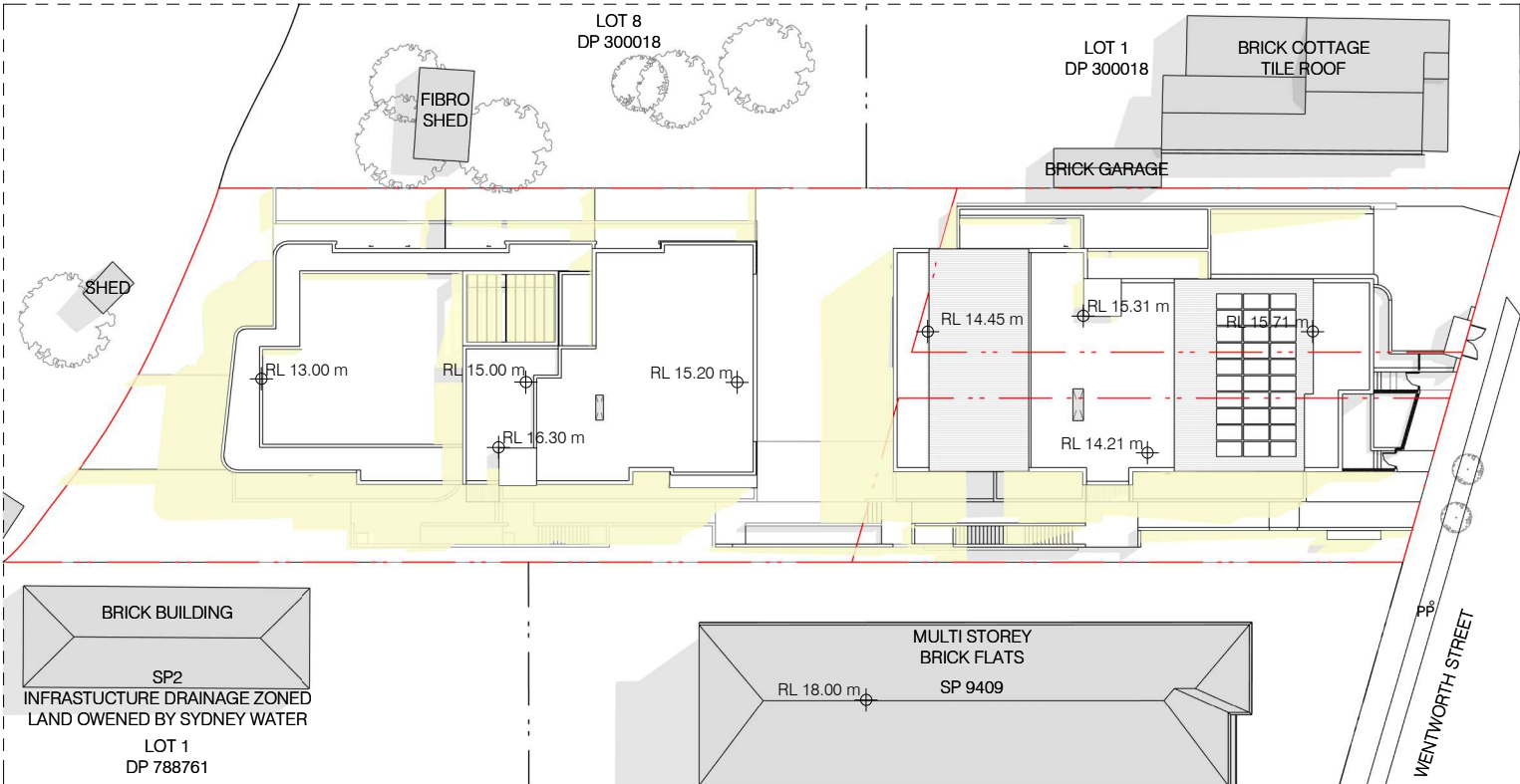



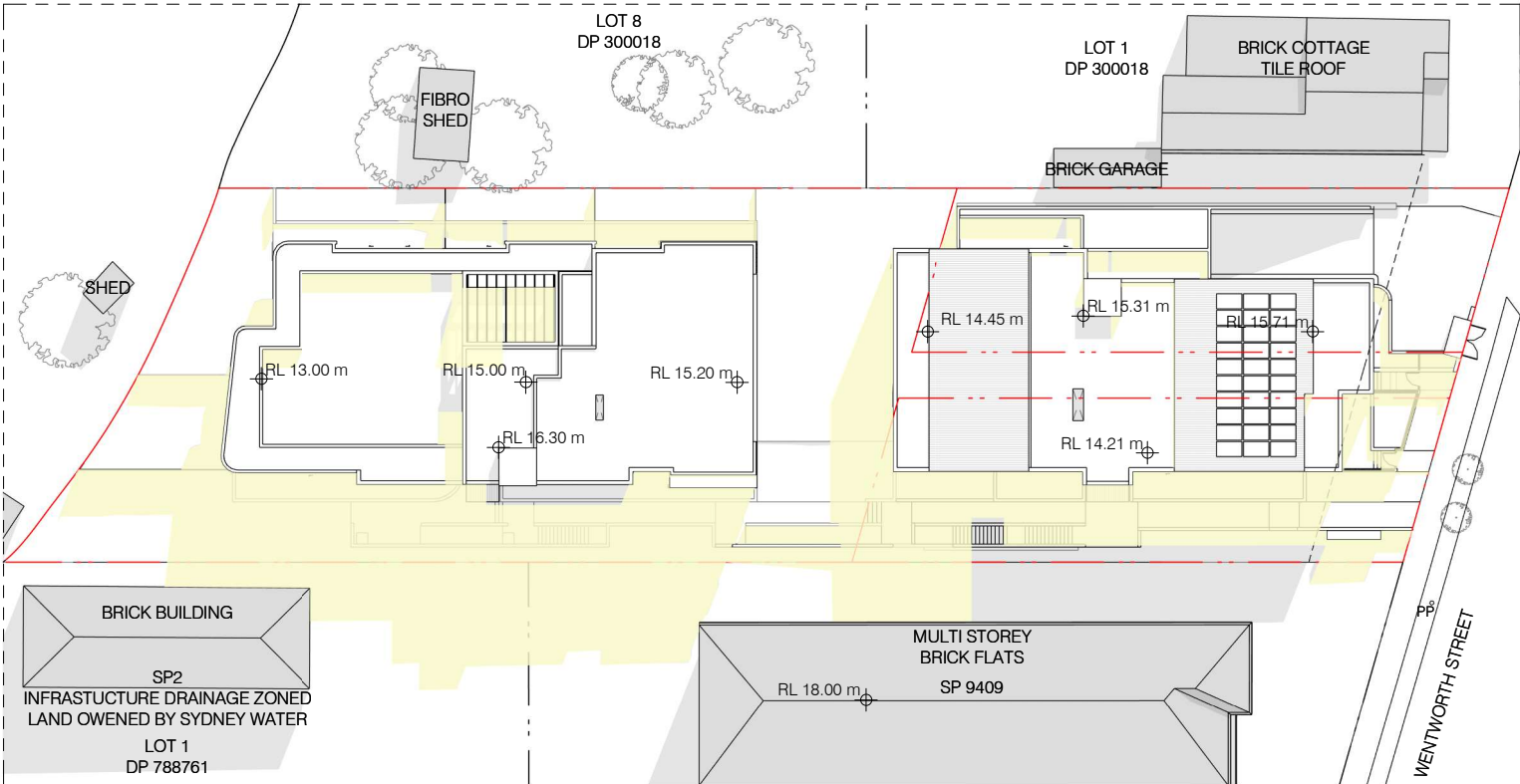
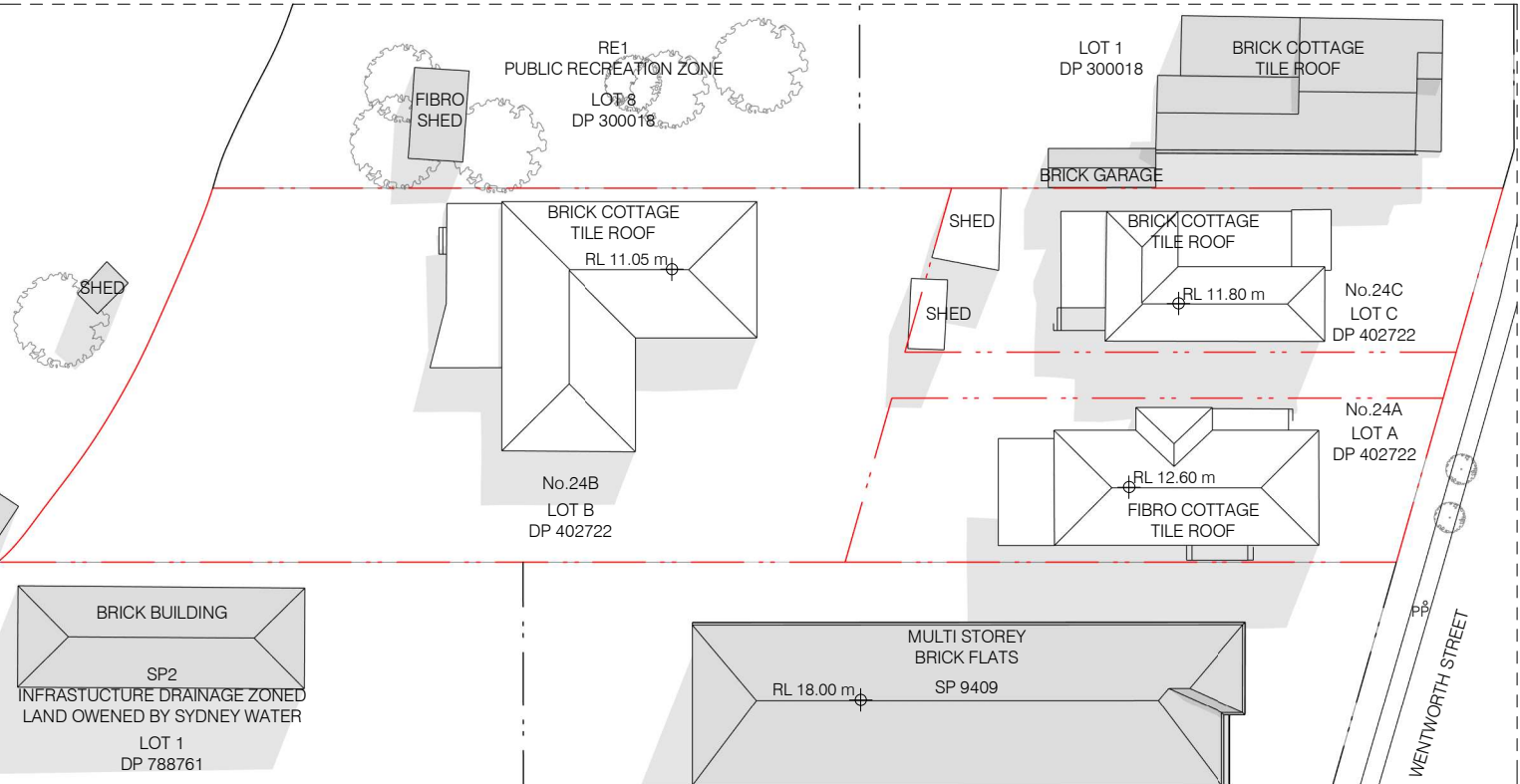
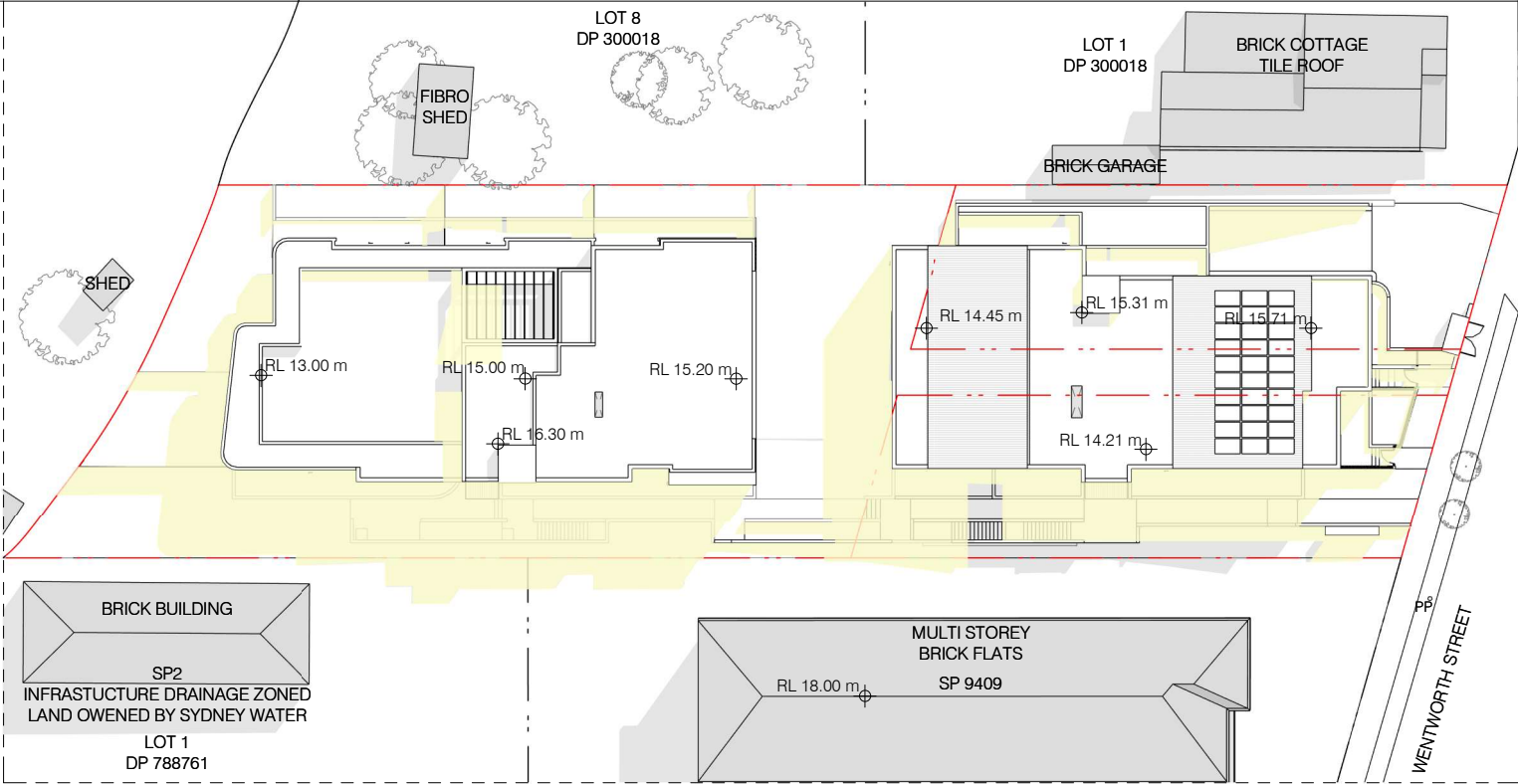
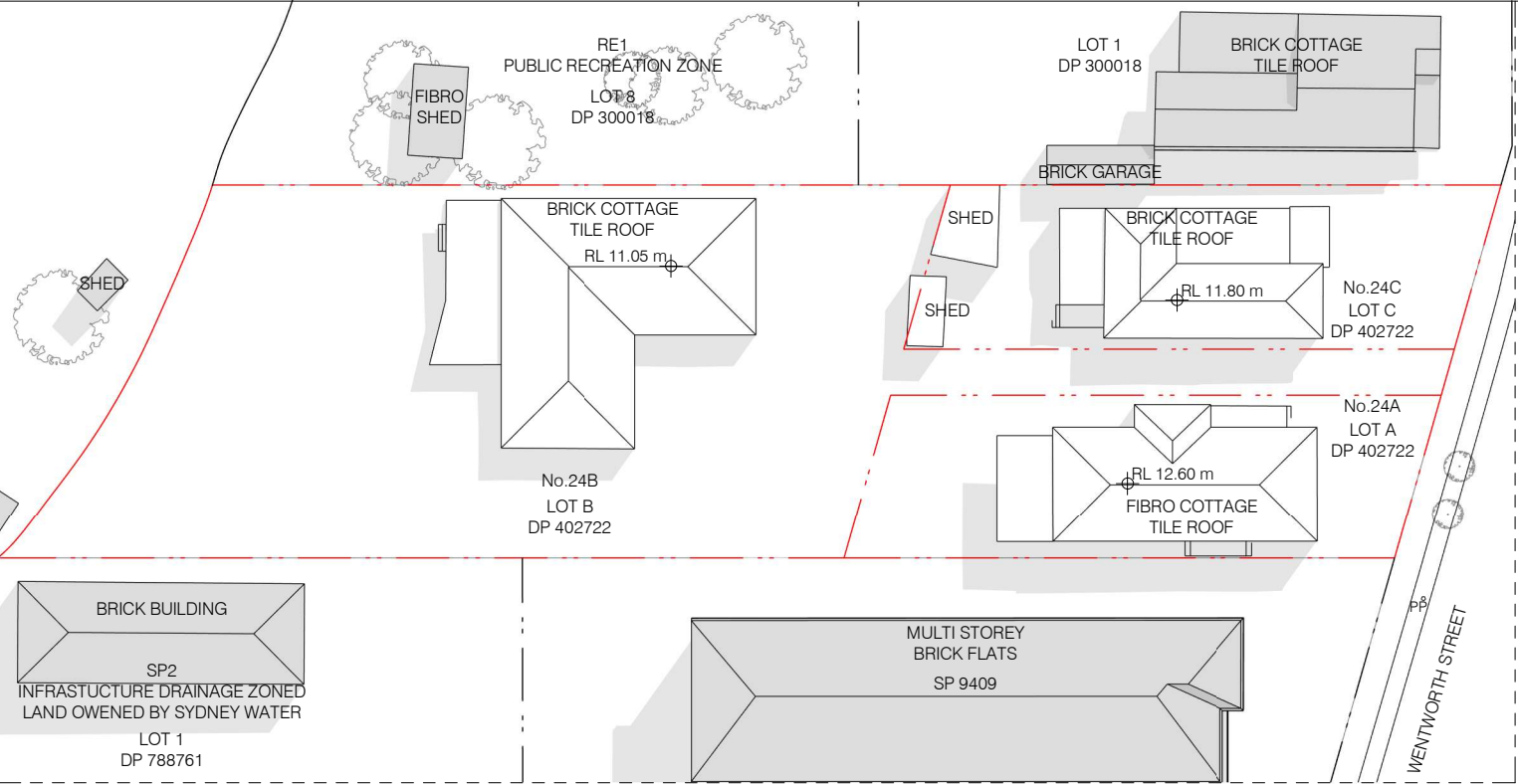

4 PROPOSED SHADOW DIAGRAM-SEPTEMBER 22- 1PM  
1 : 500

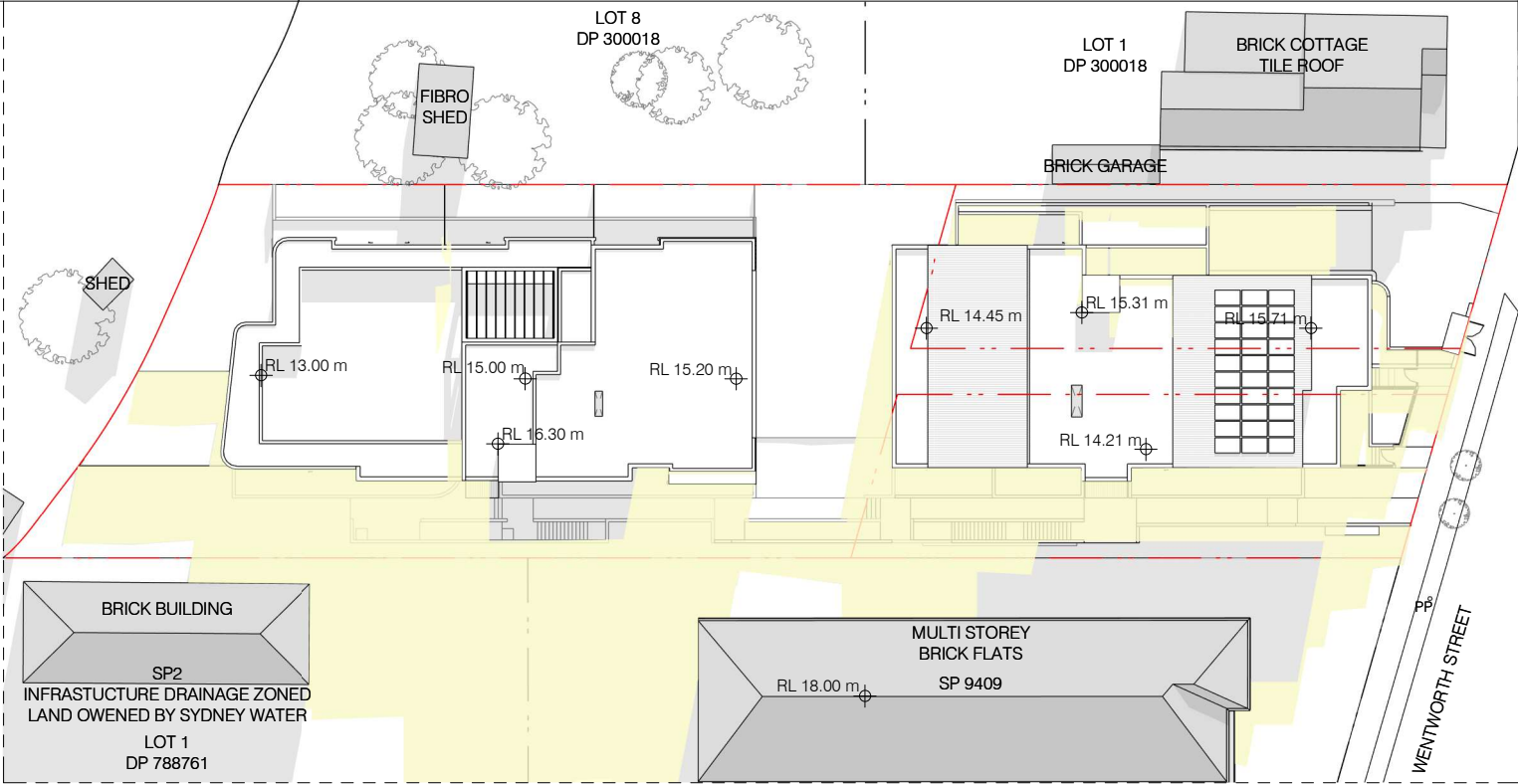
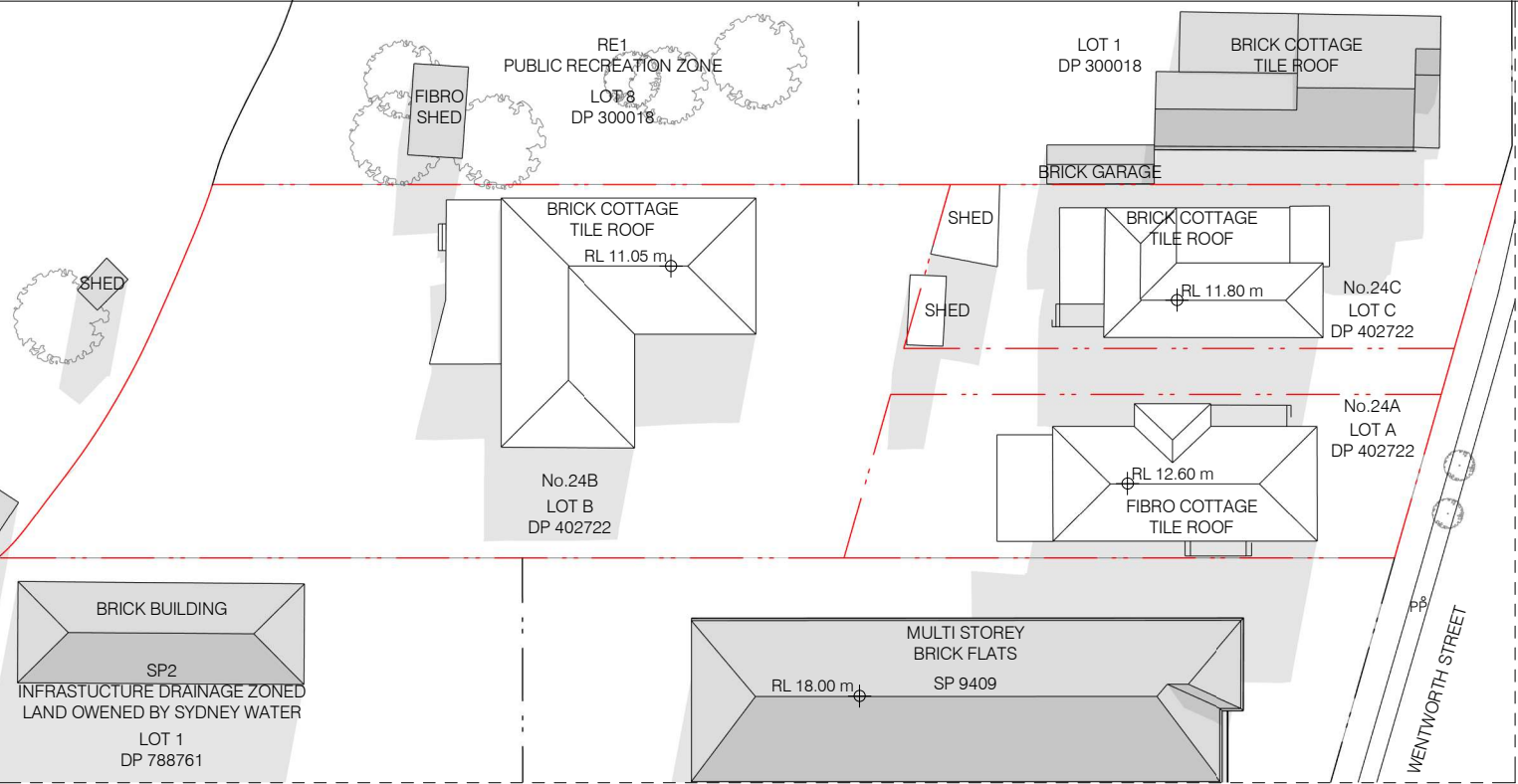





ARCHITECT		LENGEND		NORTH		ISSUE		AMENDMENT		DATE		PROJECT		SHADOW DIAGRAM - SEPTEMBER 22					
<div><div><div>t: 02 8970 5417</div><div>e: studio@bjbarchitects.com.au</div><div>a: 3.09/77 Dunning Ave,</div><div>Rosebery NSW 2018</div></div><div><div>BJB Architects Pty Ltd</div><div>Nominated Architect:</div><div>Barry Babikian NSW Reg No. 8806</div></div></div>		<div><div></div>EXISTING SHADOW</div> <div><div></div>PROPOPOSED ADDITIONAL SHADOWS</div>		<div></div>		A		ISSUED FOR DEVELOPMENT APPLICATION		28.11.2024		24A, 24B, 24C WENTWORTH ST, CROYDON PARK		NEW MULTI UNIT DWELLING DEVELOPMENT		SCALE: 1 : 500@ A3		DATE: 28.11.2024	
														ISSUE: A - ISSUED FOR DEVELOPMENT APPLICATION					
																THIS DOCUMENT IS THE COPYRIGHT OF BJB ARCHITECTS. ALL INFORMATION ILLUSTRATED ON THIS DOCUMENT IS TO BE CHECKED AND VERIFIED ON SITE. IN THE EVENT OF DISCREPANCIES REFER TO BJB ARCHITECTS PRIOR TO COMMENCEMENT OF THE WORK. DO NOT SCALE DRAWINGS MANUALLY OR ELECTRONICALLY		2022-001	
																A1618			